



Santa Cruz County Regional Transportation Commission's  
**Elderly & Disabled Transportation Advisory Committee**  
*(Also serves as the state-mandated Social Service Transportation Advisory Council)*

---

**AGENDA ~ 1:30 pm, Tuesday, October 14, 2014**  
**Regional Transportation Commission Santa Cruz Office**  
1523 Pacific Avenue, Santa Cruz, CA, 95062 (2nd Floor)

(start time  
estimate)

- |                |   |
|----------------|---|
| <b>1:30 pm</b> | <b>1. Call to Order</b>   |
| <b>1:32 pm</b> | <b>2. Introductions</b>   |
| <b>1:35 pm</b> | <b>3. Oral Communications</b><br><i>The Committee will receive oral communications during this time on items not on today's agenda. Presentations must be within the jurisdiction of the Committee, and may be limited in time at the discretion of the Chair. Committee members will not take action or respond immediately to any Oral Communications presented, but may choose to follow up at a later time, either individually, or on a subsequent Committee agenda.</i>   |
| <b>1:40 pm</b> | <b>4. Additions or deletions to the consent and regular agendas</b>   |
| <b>1:42 pm</b> | <b>CONSENT AGENDA</b><br><i>All items appearing on the consent agenda are considered to be minor or non-controversial and will be acted upon in one motion if no member of the E&amp;D TAC or public wishes an item be removed and discussed on the regular agenda. Members of the E&amp;D TAC may raise questions, seek clarification or add directions to Consent Agenda items without removing the item from the Consent Agenda as long as no other E&amp;D TAC member objects to the change.</i>                                    |
|                | <b>5. Approve minutes from August 5, 2014 meeting (page3)</b>   |
|                | <b>6. Receive Transportation Development Act (TDA) Revenues Report as of October 2014 (page 6)</b>  |
|                | <b>7. Receive September and October 2014 RTC Highlights (page 7)</b>  |
|                | <b>8. Approve Brent Gifford for District 1 Alternate (page 9)</b>   |
|                | <b>9. Receive Calendar of E&amp;D TAC Items (page 12)</b>   |
|                | <b>10. Approve County of Santa Cruz TDA Claim for Aptos Village Plan, Twin Lakes State Beach &amp; County Government Center ADA Path (page 13)</b>  |
|                | <b>11. Approve Letters of Support for Caltrans Planning Grant Applications (page 44)</b>  |
|                | <b>12. Information Items (page 46)</b> <ul style="list-style-type: none"><li>a. Letter from E&amp;D TAC to Santa Cruz Metro in Support of New Paratransit Vehicle Purchase</li><li>b. Letter from E&amp;D TAC to Santa Cruz Metro regarding Older Adult and Disabled Individual Discount Pass Program</li><li>c. Letter from RTC staff to City of Watsonville regarding Main Street Improvements</li><li>d. Letter from RTC staff to California State Coastal Conservancy regarding Twin Lakes Beachfront Improvement Project</li></ul> |

**13. Receive Agency Updates (other than items on regular agenda) (page 50)**

- a. Volunteer Center
- b. Community Bridges (Consolidated Transportation Services Agency)
- c. Santa Cruz Metropolitan Transit District (Metro): [May and June 2014 ParaCruz Report](#) (starts on page 84 of August 22, 2014 Metro board packet), [July 2014 ParaCruz Report](#) (starts on page 33 in the September 22, 2014 Metro board packet), Metro Consideration of Issuing a Formal RFP for Facilities Evaluation for ADA Compliance

**REGULAR  
AGENDA**

- 1:45pm 14. Receive Information about Metro Route 6 Performance (page 53)**
- 2:00pm 15. Presentation on Metro Pacific Station Redesign Project (page 57)**
- 2:30pm 16. Review FTA 5310 Grant Information & Identify a Local FTA 5310 Grant Review Committee (page 58)**
- 3:00pm 17. Receive Pedestrian Safety Work Group Update**
- 3:15pm 18. Adjourn**

Next meeting location and time: **1:30 pm, December 9, 2014 @ RTC Office, Santa Cruz**

Future Topics: Handicapped Parking Spaces in downtown Santa Cruz, Construction Guidelines for Accessibility, Accessibility in the San Lorenzo Valley, Pedestrian FAQ, San Mateo paratransit presentation, rides to election sites, Annual Report

**HOW TO REACH US**

*Santa Cruz County Regional Transportation Commission  
1523 Pacific Avenue, Santa Cruz, CA 95060  
Phone: (831) 460-3200 / fax (831) 460-3215  
Email: [info@sccrtc.org](mailto:info@sccrtc.org) / website: [www.sccrtc.org](http://www.sccrtc.org)*

**ACCOMMODATIONS FOR PEOPLE WITH DISABILITIES**

*The Santa Cruz County Regional Transportation Commission does not discriminate on the basis of disability and no person shall, by reason of a disability, be denied the benefits of its services, programs, or activities. This meeting location is an accessible facility. If you wish to attend this meeting and require special assistance in order to participate, please contact RTC staff at 460-3200 (CRS 800/735-2929) at least three working days in advance of this meeting to make arrangements. People with disabilities may request a copy of the agenda in an alternative format. As a courtesy to those person affected, please attend the meeting smoke and scent-free.*

**SERVICIOS DE TRADUCCIÓN/TRANSLATION SERVICES**

*Si gusta estar presente o participar en esta junta de la Comisión Regional de Transporte del condado de Santa Cruz y necesita información o servicios de traducción al español por favor llame por lo menos con tres días laborables de anticipo al (831) 460-3200 para hacer los arreglos necesarios. (Spanish language translation is available on an as needed basis. Please make advance arrangements (at least three days in advance by calling (831) 460-3200.*



**Santa Cruz County Regional  
Transportation Commission**

**Elderly & Disabled Transportation Advisory Committee**

---

**Minutes – Draft**

**Tuesday, August 5, 2014**

**Regional Transportation Commission Office  
1523 Pacific Avenue, Santa Cruz, CA 95060**

1. **Call to Order** at 1:35 pm

2. **Introductions**

***Members Present:***

Donald Hagen, 4<sup>th</sup> District  
Kirk Ance, CTSA Lift Line  
Lisa Berkowitz, CTSA  
Debbi Brooks, Soc. Serv. Provider-Persons of Limited Means  
John Daugherty, Metro Transit  
Veronica Elsea, 3<sup>rd</sup> District  
Sally French, Soc. Serv. Provider-Disabled (HOPE)  
Patti Shevlin, 1 District

***Alternates Present:***

April Warnock, Metro ParaCruz

***Excused Absences:***

***Others Present:***

Brent Gifford, Citizen  
Leslyn Syren, Santa Cruz Metro

***RTC Staff Present:***

Grace Blakeslee  
Karena Pushnik

3. **Oral Communications**

The following information was discussed or announced:

- Recognition of Les White as long time director of Santa Cruz Metro on cover of Headways
- Transit service to Big Basin State Park is available during the summer
- Santa Cruz Metro is providing free rides for youth during the summer
- Highway 17 Express connects to VTA Train 902 to provide service to the 49ers stadium
- Welcome Donald (Norm) Hagen as a member of the E&D TAC
- Introduction of Brent Gifford, citizen interested in serving as 1<sup>st</sup> District Alternate on E&D TAC

4. **Additions or deletions to consent and regular agenda - None**

**CONSENT AGENDA**

*Action: The motion (French/Shevlin) - - to approve the consent agenda as amended - - carries.*

**Ayes:** John Daugherty, Lisa Berkowitz, Debbi Brooks, Sally French, Kirk Ance, Clay Kempf, Veronica Elsea

**Nays:** None

**Abstain:** None

5. Approved minutes from June 10, 2014 meeting
  - Amend draft minutes, Item #15: Correct Pedestrian Safety Workgroup to Pedestrian Safety Workgroup
6. Received Transportation Development Act (TDA) Revenues Report as of July 2014
7. Received RTC Highlights through June 2014
8. Received Calendar of E&D TAC Items
9. Receive Information Items
  - a. Letter from Santa Cruz County Taxi Commission – July 10, 2014
  - b. AARP Article, "Making Streets Safe", April 2014
  - c. Letter from California Council of the Blind Letter Regarding AB 1193
  - d. Highway 1/9 Intersection Improvement Initial Study, RTC Staff Comments
10. Received Agency Updates
  - a. Volunteer Center
  - b. Community Bridges (Consolidated Transportation Services Agency)
    - 3rd Quarter FY 13/14 TDA Report
  - c. Santa Cruz Metropolitan Transit District (Metro)
    - April 2014 ParaCruz Report
    - Past Metro Reports
  - d. Santa Cruz County Regional Transportation Commission
    - Passenger Rail Survey
  - e. Private Operators

### **REGULAR AGENDA**

11. Reviewed Older Adult and Persons with Disabilities Fixed Route Discount Fare Program (AR- 1028)

Leslyn Syren, Santa Cruz Metro, presented proposed revisions to the Adult and Persons with Disabilities Fixed Route Discount Fare Program and associated application form. E&D TAC discussed additional contact information requested on the revised discount fare card application form and discount fare eligibility requirements. E&D TAC recommended removal of question related to use of a service animal on the revised application. E&D TAC discussed locations and hours for purchasing metro passes in Felton and Watsonville.

*Action: The motion (Elsea/Ance) to recommend E&D TAC send a letter to the Santa Cruz Metro stating that the E&D TAC supports the revisions to the Older Adult and Persons with Disabilities Fixed Route Discount Fare Program as proposed by Santa Cruz Metro staff and removal of the question related to use of service animal on the revised application -- carries.*

*Ayes: Kirk Ance, Debbi Brooks, Sally French, Lisa Berkowitz, Veronica Elsea, Patti Shevlin*  
*Nays: None*  
*Abstain: John Daugherty*

12. Receive Pedestrian Safety Work Group Update and Draft Pedestrian and Motorist Brochure

Veronica Elsea presented the draft Pedestrian and Motorist Brochure. The E&D TAC considered comments received from Mission Pedestrian to add the word "marked" before the word "crossings" in the brochure. E&D TAC appreciated Hal Anjo for his leadership in designing the brochure.

*Action: The motion (Elsea/French) to approve the draft Pedestrian and Motorist Brochure with the inclusion of the word "marked" before the word "crossings" in the brochure.*

Ayes: Kirk Ance, Debbi Brooks, Sally French, Lisa Berkowitz, John Daugherty, Veronica Elsea, Patti Shevlin  
Nays: None  
Abstain: None

Veronica Elsea discussed next steps to print and distribute the Pedestrian and Motorist Brochure. E&D TAC discussed locations for distributing the brochure and outreach ideas.

*Action: The motion (Daugherty/Berkowitz) to recommend that the RTC approve the Pedestrian and Motorist Brochure for printing and distribution.*

Ayes: Kirk Ance, Debbi Brooks, Sally French, Lisa Berkowitz, John Daugherty, Veronica Elsea, Patti Shevlin  
Nays: None  
Abstain: None

13. View Proposed New Paratransit Vehicles

April Warnock, Santa Cruz Metro, described new paratransit vehicles under consideration for purchase by Santa Cruz Metro. E&D TAC viewed a van and a minivan under consideration.

*Action: The motion (Elsea/Hagen) to recommend that E&D TAC send a letter to Santa Cruz Metro to recommend purchase of the proposed new paratransit vehicles.*

Ayes: Kirk Ance, Debbi Brooks, Sally French, Lisa Berkowitz, John Daugherty, Veronica Elsea, Patti Shevlin  
Nays: None  
Abstain: None

17. Adjourn 3:30 pm

Respectfully submitted, Grace Blakeslee, RTC Staff

**SANTA CRUZ COUNTY REGIONAL TRANSPORTATION COMMISSION  
TDA REVENUE REPORT  
FY 2014-2015**

<b>MONTH</b>	<b>FY13 - 14 ACTUAL REVENUE</b>	<b>FY14 - 15 ESTIMATE REVENUE</b>	<b>FY14 - 15 ACTUAL REVENUE</b>	<b>DIFFERENCE</b>	<b>DIFFERENCE AS % OF PROJECTION</b>	<b>CUMULATIVE % OF ACTUAL TO PROJECTION</b>
JULY	556,100	583,905	591,100	7,195	1.23%	101.23%
AUGUST	741,500	778,575	788,200	9,625	1.24%	101.23%
SEPTEMBER	818,354	859,272	791,871	-67,401	-7.84%	97.72%
OCTOBER	596,900	626,745				
NOVEMBER	795,900	835,695				
DECEMBER	732,985	769,634				
JANUARY	557,700	595,461				
FEBRUARY	728,800	793,948				
MARCH	802,890	704,655				
APRIL	504,100	530,042				
MAY	672,100	706,686				
JUNE	780,261	845,925				
<b>TOTAL</b>	<b>8,287,590</b>	<b>8,630,543</b>	<b>2,171,171</b>	<b>-50,581</b>	<b>-0.59%</b>	<b>25%</b>

**Note:**

I:\FISCAL\TDA\MonthlyReceipts\[FY14 - 15.xlsx]FY2014



*Santa Cruz County Regional Transportation Commission  
1523 Pacific Avenue, Santa Cruz, CA 95060  
phone (831) 460-3200 ~ fax (831) 460-3215  
email: [info@sccrtc.org](mailto:info@sccrtc.org); website: [www.sccrtc.org](http://www.sccrtc.org)*

## **Santa Cruz County Regional Transportation Commission (RTC) August 7, 2014 Meeting Highlights**

### ***Travel Time and Travel Time Reliability for Highway 1:***

The RTC received a report on travel time and travel time reliability for Highway 1 based on data aggregated from Caltrans detectors along the highway through the Performance Measurement System (PeMs). The report includes graphs showing variability in travel time during different times of day, in both northbound and southbound directions between Watsonville and Santa Cruz. Projected travel time and travel time reliability for 2035 based on implementation of projects prioritized in the approved 2014 Regional Transportation Plan was also discussed. The full report is available on the RTC's website at: <http://www.sccrtc.org/wp-content/uploads/2010/09/2014-08-07-rtc-agenda-packet.pdf#page=112>

### ***Passenger Rail Study Update:***

An update was provided to the RTC regarding the public input and information gathering phase of the Caltrans-grant funded Passenger Rail Study to evaluate the feasibility of passenger rail service on the Santa Cruz Branch Rail Line. RTC staff and interns conducted a massive outreach campaign to encourage public feedback via an online survey, an abbreviated paper survey in English and Spanish, and a workshop held in mid-county. The survey was completed by almost 2,000 participants and an overflow crowd attended the workshop. Staff provided the RTC with a few highlights from the data gathered. Next steps include technical stakeholder and rail peer review meetings, after which materials will be refined by consultants to present their recommendations to the RTC at the September 4<sup>th</sup> meeting. At that meeting, the Commission will be asked to approve 3 to 5 service scenarios to undergo detailed ridership and cost analysis.

### ***Santa Cruz Branch Rail Line Right-of-Way Lease, License and Right of Entry Policy:***

The RTC approved new policies for leases, licenses and rights of entry for the Santa Cruz Branch Rail Line right-of-way (ROW). Real estate rights, property improvements, encumbrances, responsibilities leases and revenues associated with rail right of way were transferred to the RTC with the completion of public acquisition in 2012. The approved policies will allow the RTC to: fulfill goals for purchasing the Branch Line ROW; meet all laws, regulations and requirements applicable to the RTC's ownership of the Branch Line ROW; protect the interests of the RTC and the public; provide revenue to help ensure that the Branch Line ROW is a good and sound community asset; and allow uses of the property that are useful to the community and do not interfere with or unduly burden the transportation uses, the RTC or the rail service operator.



*Santa Cruz County Regional Transportation Commission  
1523 Pacific Avenue, Santa Cruz, CA 95060  
phone (831) 460-3200 ~ fax (831) 460-3215  
email: [info@sccrtc.org](mailto:info@sccrtc.org); website: [www.sccrtc.org](http://www.sccrtc.org)*

## **Santa Cruz County Regional Transportation Commission (RTC) September 4, 2014 Meeting Highlights**

### ***Passenger Rail Study—Goals, Evaluation Metrics, and Scenarios:***

The RTC approved goals and objectives, an evaluation framework, station locations and service scenarios for analysis in the Passenger Rail Study for the Santa Cruz Branch Rail Line. The RTC's consultant team will now conduct its study based on these approved guidelines, and report back on their technical analysis of different service options later this year. The consultant team is also analyzing opportunities and constraints for various train technologies, including track classification, frequency of passenger trains, freight use of the rail line, Federal Railroad Administration (FRA) compliance, short term capital costs, ongoing maintenance and operating costs, and other parameters. The draft study and final reports will be available for public review in Spring 2015.

### ***2013 Annual Report for Safe on 17 Safety Corridor Project:***

The 2013 Safe on 17 Program included extra enforcement on Highway 17, collision and citation rate monitoring, Safe on 17 Task Force Meetings, public information and outreach, and highway safety improvements. During 2013, the program surpassed the goal of maintaining the reduced injury and fatal collisions experienced during the initial Office of Traffic Safety grant period. The total number of collisions for 2013 was 420, which ties with 2009 for the lowest number of collisions on record since 1996. There were a total of 1,152 hours of extra CHP enforcement for the year, which increases the number of citations being issued on Highway 17, providing a deterrent to motorists who practice unsafe driving behavior. Also in 2013, Caltrans advanced or completed several important safety projects on Highway 17, including the Guardrail Improvement Project, the Santa's Village Road Guardrail Project, and the Highway 17 Summit Slide Repair Project.

I:\Highlights\2014\2014-09-04-highlights.docx



# COMMITTEE APPOINTMENT APPLICATION

## Santa Cruz County Regional Transportation Commission (SCCRTC) Elderly & Disabled Transportation Advisory Committee (E/D TAC)

Meetings are scheduled for the second Tuesday of every other month at 1:30 p.m. in the Santa Cruz County Regional Transportation Commission conference room, located at 1523 Pacific Avenue in downtown Santa Cruz. At least one meeting each year is scheduled for an alternate location. Please refer to the Committee description, bylaws and recruitment process for more information.

If you are interested in serving on this committee, please complete this application, and return it to the Regional Transportation Commission office.

### PLEASE TYPE OR PRINT CLEARLY

Name: Brent A. Gifford

Home address: 2655 Brommer St #45 Santa Cruz, CA 95062

Mailing address (if different): \_\_\_\_\_

Phone: (home) 831-471-8442 (business/<sup>cell</sup>message) 831-334-2586

E-mail: hypnogift@yahoo.com

Length of residence in Santa Cruz County: 12 yrs

Position(s) I am applying for: ☐ Any appropriate position

☒ ED TAC committee member ☐ \_\_\_\_\_

Previous experience on a government commission or committee (please specify)

Please see attached.

\_\_\_\_\_  
\_\_\_\_\_  
\_\_\_\_\_  
\_\_\_\_\_  
\_\_\_\_\_  
\_\_\_\_\_

## Relevant Work or Volunteer Experience

Organization	Town or Address	Position	Dates
Oakland Blind Center	Oakland, CA	Senior Program Coordinator Coordinated ADA training for BART + ACTransit employees	1999-2002
UCSC - Computer/Assistive Technology Dept.	Santa Cruz, CA	Research + Development + lecturing for assistive technology	2005 - current
Vista Center for the Blind	Santa Cruz, CA	Support group Coordinator	2003 - 2005
MDI	Santa Cruz, CA	(Volunteer) project management for various local projects + events	2002 - current

**Statement of Qualifications:** Please attach a brief statement indicating why you are interested in serving on this committee and why you are qualified for the appointment. If you have served on this committee in the past, please summarize your accomplishments on the committee and indicate which of the committee's potential future endeavors most interest you.

**Certification:** I certify that the above information is true and correct and I authorize the verification of the information in the application in the event I am a finalist for the appointment.

\_\_\_\_\_  
Signature

\_\_\_\_\_  
Date

**Return Application to:** SCCRTC  
Elderly & Disabled Transportation Advisory Committee  
1523 Pacific Avenue  
Santa Cruz, CA 95060  
fax: 460-3215 email: [kpushnik@sccrtc.org](mailto:kpushnik@sccrtc.org)

**Questions or Comments:** (831) 460-3200

August 4, 2014 EDTAC Application Attachment

My name is Brent Gifford, I live at 265545 Brommer St.#45 Santa Cruz CA 95062,. (Antonelli's Senior Community) I have lived in Santa Cruz County since 2002. I have been a provisional client of Metro Paracruise and have used the fixed route system when I lived close enough to a stop. I have a disease which affects my bones and muscles as well as causing the loss of my sight.

I believe that I would be a good fit on the EDTAC due to my experience in the disabled services industry for the past 35 years. I was one of the first people ever to hear and help create the voice and the mechanical speech which we all take for granted now. I have been part of a number of research and development projects designed to make the quality of life comparable for persons with disabilities. At present at UCSC, I am involved with a project which will utilize any phones camera to read aloud SCMTD signage including posted schedules at the stops themselves and the bus numbers at a reasonable distance from the stop. I also am consulting with a large telecommunications company to help make the products more user friendly for persons with disabilities.

I have consulted with safety committees on 6 different public transit companies around the country. I reviewed policies and procedures as they related to serving (pwd) from how to move them around in the systems to specific evacuation procedures in case of emergencies. I was trained as an extrication specialist years ago and spent some of my time as an accident victim and evaluating the EMT's process and procedures,

As part of my employment with Lighthouse for the Blind in San Francisco and Lions Blind Center in Oakland, my duties included training drivers and platform personnel for BART, Muni, and AC Transit. I taught how to deal with those impossible people who make your day longer with all those special needs requests.. I also was an ADA advocate once that came to pass.

I don't necessarily agree with everything included in the ADA, but what I do believe in is a level playing field. I think that people who need help from "public" transportation deserves the right to transportation whether or not they live directly on a fixed route system which is the only responsibility of paracruz. I do understand that we are fortunate in this county to also have Liftline to pick up some of the slack. I am looking forward to getting to know and understand the SCMTD system better to better serve my community. Thank you for your time and consideration. Brent Gifford.

# **Elderly & Disabled Transportation Advisory Committee**

## ***Annual Meeting Schedule***

*Most meetings held on the 2<sup>nd</sup> Tuesday of even numbered months at 1:30 pm in the SCCRTC Conference room,  
\*one meeting held annually in an alternate location*

This is a draft list of meeting topics. Please check the RTC website for the current packet agenda (posted about 4 working days before the meeting).

- February*      Review Draft of **Annual Report including Unmet Needs**, suggest outreach for Mar RTC hearing  
Review **Annual TDA Plan & Preliminary TDA Estimates**, if available  
Solicit **Nominations for Chair/Vice Chair**
- April*            Review **TDA Claims for Volunteer Center, Community Bridges and METRO**  
Elect **Chair and Vice Chair**  
Review **Roster/Membership update**  
Info/Consent items: **final Unmet Needs list or link** to list on website
- June*             Review **Metro's Section 5311 Project Program/Application**, if necessary
- August*          Review **RTC's Legislative Report**
- October*         Determine **Local Review Committee for Section 5310 Applications**
- December*      Review draft **Unmet Transit Needs and determine outreach plan** (coordinate with Area on the Aging Unmet Needs)  
Review **End of FY TDA Claims**  
Review **next year's Meeting Schedule**
- Info items:*    **Minutes** from last meeting  
Monthly **TDA Revenues** (get from latest RTC packet)  
**RTC Highlights** (w/o meeting list)  
**Letters** from the committee  
**Letters** from RTC staff related to E&D TAC activities  
**Agency Updates**, including **Quarterly TDA reports**
- As Needed:*    Recommend **TDA Claims from local jurisdictions**  
Review **Updates to Guide for Specialization**  
Review **Triennial Performance Audit** (every 3 years)  
Review **Coordinated Plan** (update every 4 years)  
Review **METRO's Short Range Transit Plan** (every 5 years)  
Consider **Committee Appointments**  
**Other timely items that are within the purview of the committee**

**Parking:** There is a parking structure located at the corner of Locust and Cedar. The cost to park in the structure is minimal (\$1 for two hours).

**Bus:** The Pacific Station MetroCenter, a destination for most buses, is approximately four blocks down Pacific Avenue. The following bus route stops on Cedar Street approximately one block from the office: the 'Route 10 via High' while outbound from the MetroCenter toward UCSC.

**TO:** RTC's Citizen Advisory Committees

**FROM:** Cory Caletti and Grace Blakeslee, Senior Transportation Planners

**RE:** Transportation Development Act (TDA) Article 8 Allocation Requests from the County of Santa Cruz

---

### **RECOMMENDATIONS**

Staff recommends that the Elderly and Disabled Transportation Advisory Committee recommend that the Regional Transportation Commission approve by resolution the County of Santa Cruz's Article 8 Transportation Development Act (TDA) allocation requests for the following bicycle and pedestrian projects:

1. Aptos Village Plan Improvement Project – Transfer of \$137,926.31 from funds previously allocated to the Calabasas School Pedestrian and Bicycle Safety Improvement Project;
  2. Bike Lane Maintenance – A total of \$435,000 in FYs 2012/13 through 2014/15;
  3. Monterey Bay Sanctuary Scenic Trail Network – A total of \$86,822 in FYs 2011/2012 through 2014/2015 for Twin Lakes State Beach Beachfront project; and
  4. County Government Center ADA Path – A total of \$15,000 in FY 2014/2015.
- 

### **BACKGROUND**

The Transportation Development Act (TDA) was established by the State Legislature in 1971. The TDA provides one of the major funding sources for public transportation in California. TDA funds are also used by local jurisdictions for bicycle and pedestrian projects. TDA funds are apportioned annually to local jurisdictions in Santa Cruz County by the RTC according to population using an approved formula in the RTC Rules & Regulations. Unused TDA funds allocated to any project may be rolled over from one fiscal year to the next.

As stated in the RTC Rules and Regulations, a TDA Article 8 claim form shall include the following: 1) a description of the project; 2) justification for the project including a statement regarding its consistency and relationship with the Regional Transportation Plan; 3) estimated cost of the project including other funding sources; 4) an agreement to maintain the funded project for a period of 20 years; and 5) preferred method of disbursement.

The Elderly & Disabled Transportation Advisory Committee (E&D TAC) reviews and makes recommendations regarding TDA applications for pedestrian projects and the Bicycle Advisory Committee reviews and makes recommendations regarding claims for bicycle projects.

**DISCUSSION**

The County of Santa Cruz is requesting allocations of FY 2011/12, FY 2012/13 and FY 2014/15 funds for four separate projects. Claim forms for each project containing background and budget information are attached for committee review. The Elderly and Disabled Transportation Advisory Committee will review the claim with a pedestrian component and make a recommendation on October 14<sup>th</sup>, 2014 and the Bicycle Advisory Committee will do the same at the October 20<sup>th</sup>, 2014 meeting.

The improvement projects are:

- Aptos Village Plan Improvement Project – Transfer of \$137,926.31 from funds previously allocated to the Calabasas School Pedestrian and Bicycle Safety Improvement Project for improvements to the bicycle and pedestrian network adjacent to Soquel Drive and Trout Gulch Road corridors;
- Bike Lane Maintenance – A total of \$435,000 in FYs 2012/13 through 2014/15 to re-stripe, sign, conduct minor repairs, trim brush and trees, and sweep the bike lanes located on major arterial roads in the unincorporated area of the County;
- Monterey Bay Sanctuary Scenic Trail Network (Trail Network) – A total of \$86,822 in FYs 2011/2012 through 2014/2015 for Twin Lakes State Beach Beachfront project which is identified in the Trail Network Master Plan as part of the 50-mile system of bicycle and pedestrian facilities; and
- County Government Center ADA Path – \$15,000 in FY 2014/2015 for an ADA pedestrian path from the existing bus stop on Ocean Street to the County Building.

Attachment 1 is a letter from John Presleigh, Director of Public Works for the County of Santa Cruz, requesting a TDA Article 8 funding allocation for four claims (Attachments 2 through 5) which includes a transfer of funds from a previously allocated project. The RTC is scheduled to consider these claims at their next meeting.

Staff recommends that the RTC's Citizen Advisory Committees recommend that the RTC approve the County of Santa Cruz allocation requests. All projects are consistent with the 2014 Regional Transportation Plan.

**SUMMARY**

The County of Santa Cruz is requesting an allocation of TDA Article 8 funds for four bicycle and pedestrian improvement projects which includes a transfer of funds previously allocated to another project. Staff recommends that the RTC's Citizen Advisory Committees recommend that the RTC approve the County's allocation request.

Attachment 1: Article 8 TDA Allocation Request Letter from County of Santa Cruz Public Works Director John Presleigh

Attachment 2: Aptos Village Plan Improvement Project Claim Form

Attachment 3: Bike Lane Maintenance Claim Form

Attachment 4: Sanctuary Scenic Trail – Twin Lakes State Beach Claim Form

Attachment 5: County Government Center ADA Path Claim Form

I:\E&DTAC\2014\10-October14\TDA\_County\SR\_CountyTDAclaim.docx



JOHN J. PRESLEIGH  
DIRECTOR OF PUBLIC WORKS

# County of Santa Cruz

## DEPARTMENT OF PUBLIC WORKS

701 OCEAN STREET, ROOM 410, SANTA CRUZ, CA 95060-4070  
(831) 454-2160 FAX (831) 454-2385 TDD (831) 454-2123



September 26, 2014

GEORGE DONDERO, EXECUTIVE DIRECTOR  
SANTA CRUZ COUNTY REGIONAL TRANSPORTATION COMMISSION  
1523 Pacific Avenue  
Santa Cruz, CA 95060

SUBJECT: TRANSPORTATION DEVELOPMENT ACT ARTICLE 8 PROJECT  
ALLOCATION CLAIMS

Dear Mr. Dondero:

The County of Santa Cruz Department of Public Works submits the four enclosed Transportation Development Act (TDA) Article 8 allocation claims for the three fiscal years 2012/2013, 2013/2014, and 2014/2015, and a claim for a remainder allocation from fiscal year 2011/2012 of \$5,394. The TDA funds available for **FY 2012/2013** equal **\$161,531**, for **FY 2013/2014** equal **\$182,996**, and **FY 2014/2015** equal **\$186,901**. One of the project claims is to request reallocation of previously allocated funds from the completed Calabasas School Safety Improvement Project to a project in Aptos Village; one claim is to continue funding bike lane maintenance; one claim is for the Sanctuary Scenic Trail project at Twin Lakes State Beach; and, the fourth claim is for pedestrian ADA path improvements at the County Government Center.

### APTOS VILLAGE PLAN IMPROVEMENT PROJECT

An allocation claim for a previously approved **FY 2011/2012** allocation claim for the Calabasas School Safety Improvement Project is requested for the Aptos Village Plan Improvement Project. All TDA allocations for the Calabasas School Safety Improvement Project totaled \$429,842. The Calabasas School Safety Improvement Project has been constructed and accepted as completed by the County Board of Supervisors with a remaining TDA allocation balance of **\$137,926.31** (\$42,984.20 not yet disbursed from SCCRTC account, and \$94,942.11 remaining balance in County account). The County requests reallocation of these remaining funds to the Aptos Village Plan Improvement Project which proposes substantial improvements to the pedestrian and bicycle network adjacent to the Soquel Drive and Trout Gulch Road corridors. These funds are expected to be used for the design and construction of these multi-modal improvements.

## BIKE LANE MAINTENANCE

An allocation claim for **\$150,000** each fiscal year for **FY 2012/2013** and **FY 2013/2014**, plus **FY 2014/2015** funds of **\$135,000** for a total three year amount of **\$435,000** is requested for bike lane maintenance of County roads. Basic road maintenance funding continues to be scarce and TDA funds have been used for this program in years past. The funding will allow County crews and contractors to re-stripe, sign, conduct minor repairs, trim brush and trees, and sweep the bike lanes which are located on major arterial roads in the unincorporated area of the County. Bike lane maintenance is critical to supporting traffic safety on County roads.

## SANCTUARY SCENIC TRAIL – TWIN LAKES STATE BEACH

An allocation claim for **FY 2011/2012**, **FY 2012/2013**, **FY 2013/2014** and **FY 2014/2015** funds in the combined total amount of **\$86,822** is requested for the Twin Lakes State Beach Sanctuary Scenic Trail project (**FY 2011/2012 = \$5,394**, **FY 2012/13 = \$11,531**, **FY 2013/2014 = \$32,996**, and **FY 2014/2015 = \$36,901**). These TDA funds will be used to construct the pedestrian and bike improvements on East Cliff Drive fronting Twin Lakes State Beach.

## COUNTY GOVERNMENT CENTER ADA PATH

An allocation claim for **FY 2014/2015** funds in the amount of **\$15,000** is requested for the County Government Center ADA Path project. This capital improvement project will implement an ADA pedestrian path of travel from the existing bus stop on Ocean Street to the County building. These TDA funds will be used to supplement other funds since the project costs are approximately \$95,000.

The County Board of Supervisors has adopted the attached resolution consistent with the above requested TDA allocations for these projects.

The Department of Public Works thanks you for accepting our request for allocations of TDA funding. The preferred method of disbursement is by means of County journal (AUD48) whereby the TDA Article 8 funds should be transferred to Budget Index 621220, subobject 1582. Please contact Jack Sohriakoff, Senior Civil Engineer, at (831) 454-2160 if you have any questions or require additional information.

Yours truly,



JOHN J. PRESLEIGH  
Director of Public Works

JRS:yv

Enclosures/Attachment

20142015allocationvclaimsylv.doc



BEFORE THE BOARD OF SUPERVISORS  
OF THE COUNTY OF SANTA CRUZ, STATE OF CALIFORNIA

0325

RESOLUTION NO. 237-2014

On the motion of Supervisor Leopold  
duly seconded by Supervisor Caput  
the following resolution is adopted:

RESOLUTION AUTHORIZING THE DEPARTMENT OF PUBLIC WORKS TO  
SUBMIT FOUR TRANSPORTATION DEVELOPMENT ACT  
ARTICLE 8 PROJECT ALLOCATION CLAIM FORMS TO THE  
SANTA CRUZ COUNTY REGIONAL TRANSPORTATION COMMISSION

WHEREAS, the Santa Cruz County Regional Transportation Commission is the  
administrating agency of the Transportation Development Act (TDA) Article 8 funds; and

WHEREAS, the County of Santa Cruz is allocated TDA funds every fiscal year through  
the Article 8 allocation claim process; and

WHEREAS, the County of Santa Cruz Department of Public Works has capital  
improvement and maintenance projects related to bicycle and pedestrian facilities consistent with  
TDA Article 8.

NOW, THEREFORE, BE IT RESOLVED that the Board of Supervisors of the County of  
Santa Cruz:

1. Approve the filing of four TDA Article 8 claims to the Santa Cruz County  
Regional Transportation Commission for the Aptos Village Improvement  
Project, Bike Lane Maintenance, the Sanctuary Scenic Trail – Twin Lakes State  
Beach, and the County Governmental Center Americans with Disabilities Act  
Path projects for the fiscal years and amounts stated in the attached claim forms.
2. Appoint the Director of Public Works, and the Department of Public Works,  
administrating agency applicant to execute and submit all documents including,  
but not limited to applications, agreements, amendments, payment requests,  
etc., which may be necessary for the completion of the aforementioned projects.

30

PASSED AND ADOPTED by the Board of Supervisors of the County of Santa Cruz, State of California, this 16th day of September, 2014, by the following vote:

AYES: SUPERVISORS Leopold, Coonerty, Caput, McPherson & Friend  
NOES: SUPERVISORS None  
ABSENT: SUPERVISORS None

**ZACH FRIEND**

Chairperson of said Board

ATTEST: **TESS FITZGERALD**  
Clerk of said Board

Approved as to form:

  
Office of County Counsel

Distribution: County Counsel  
Public Works

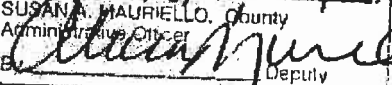
STATE OF CALIFORNIA	)	ss
COUNTY OF SANTA CRUZ	)	
I, SUSAN A. MAURIELLO, County Administrative Officer and ex-officio Clerk of the Board of Supervisors of the County of Santa Cruz, State of California do hereby certify that the foregoing is a true and correct copy of the resolution passed and adopted by and entered in the minutes of the said board. In witness whereof I have hereunto set my hand and affixed the seal of the said Board on <u>September 16, 2014</u> .		
SUSAN A. MAURIELLO, County Administrative Officer		
 Deputy		

**Transportation Development Act (TDA) – Local Transportation Funds  
CLAIM FORM  
for Bike/Ped Projects**

*If you have any questions about this claim form or would like an electronic copy of the form,  
please contact the Santa Cruz County Regional Transportation Commission at 460-3200.*

**Project Information**

1. Project Title: Phase I, Aptos Village Plan Improvements
2. Implementing Agency: County of Santa Cruz
3. Sponsoring Agency (if different) – must be a TDA Eligible Claimant:
4. TDA funding requested this claim: \$137,926.31
5. Fiscal Year (FY) for which funds are claimed: FY 2011/2012 (reallocation of previously allocated funds for the Calabasas School Safety Improvement Project which had been completed and has an overall remaining TDA balance of \$137,926.31).
6. General purpose for which the claim is made, identified by the article and section of the Act which authorizes such claims: ☒ **Article 8 Bicycle and/or Pedestrian Facility**
7. Contact Person/Project Manager: Jack Sohriakoff, Senior Civil Engineer  
Telephone Number: (831) 454-2160 E-mail: Jack.Sohriakoff@santacruzcounty.us  
  
Secondary Contact (in event primary not available) : Greg Martin, Civil Engineer  
Telephone Number: (831) 454-2160 E-mail: Greg.Martin@santacruzcounty.us
8. Project/Program Description/Scope (use additional pages, if needed, to provide details such as work elements/tasks): This capital improvement project will implement the recommendations of the Aptos Village Plan improving transportation for pedestrians and bicyclists throughout the community and along the Soquel Drive and Trout Gulch Road transportation corridors adjacent to the Aptos Village center. **Phase I** will consist of the improvements at the intersection of Soquel Drive and Trout Gulch Road and along Trout Gulch Road to Valencia Street. **Phase II** is dependent upon the CPUC approval of the other two at-grade railroad crossings at Aptos Creek Road and a new road named Parade Street. The County has already obtained CPUC approval for improvements to the Trout Gulch Road railroad crossing, and submitted the other two applications in April 2014.

**Soquel Drive**

The proposed project provides a comprehensive design for pedestrian and bicycle traffic along Soquel Drive from 350 feet west of Aptos Creek Road to 200 feet east of Trout Gulch Road. Sidewalk will be along the entire length of the south side of the road for the project. Along the north side, sidewalk will tie into existing sidewalk and provide access to the town center and a new bus stop providing a complete pedestrian network access on either side of the road. The existing bike lanes along this segment will be retained and enhanced.

Trout Gulch Road

Trout Gulch Road has been designed with new curb, gutter, and sidewalk along the east side from the intersection of Soquel Drive to Valencia Street. The project plans incorporate all necessary ADA facilities. The west side of the road is being modified to provide ADA access and safety railing due to the steep drop offs from the top of the sidewalk to the road. On street parking on the west side will officially be removed. New standard width bike lanes will be provided along this segment.

Traffic Signals/Railroad Xings

Traffic signals are proposed at the intersections of Soquel Drive/Aptos Creek Road and Soquel Drive/Trout Gulch Road. These traffic signals will provide protected pedestrian crossings and enhanced bike lane turning movements. The railroad crossing improvements will meet current federal requirements for pedestrian and bicycle crossings.

9. Number of people to be served/anticipated number of users of project/program: Estimated County population in 2012 = 266,776 people. Estimated bike riders: 4% of population = 10,670 bicyclists. Estimated pedestrians: 2% of population = 5,335 pedestrians. Total users = 16,005. Bike riders and pedestrians consist of commuters, students, and recreational users. These are considered direct daily users that can be served throughout the County but only a relative percentage will be served by this project.
10. Project Location/Limits (attach a map and/or photos if available/applicable, include street names):  
The limits on Soquel Drive are from the Aptos Creek Bridge to 200 feet east of Trout Gulch Road, and on Trout Gulch Road they are from Soquel Drive to Valencia Street.
11. Justification for the project. (Why is this project needed? Primary goal/purpose of the project; problem to be addressed; project benefits; importance to the community): The goal is to provide additional infrastructure for pedestrians and bicyclists per the County Board of Supervisors approved Aptos Village Plan.
12. Consistency and relationship with the Regional Transportation Plan (RTP) – please reference Project or Policy number:  
  
Policy 2.1- Ensure that all major corridors provide a choice of transportation modes and are designed with multi-modal amenities such as bus stops, turnouts and shelters, bike lanes and sidewalks.  
Policy 4.1 – Emphasize sustainable transportation modes consistent with regional environmental policies.  
Policy 4.2 – Ensure that transportation projects contribute to improved regional air quality, reduce energy consumption or reduce vehicle miles traveled, or, at a minimum, do not worsen existing conditions.
13. Measures of performance, success or completion to be used to evaluate project/program:  
Infrastructure improvements are to be consistent with the Aptos Village Plan and all relative design criteria standards, and conform to current ADA requirements.
14. Impact(s) of project on other modes of travel, if any (ex. parking to be removed):  
The bike lanes on Trout Gulch will require the removal of on street parking along the west side of this segment, but the parking is very rarely used. In addition, these multi-modal infrastructure improvements will lead to a reduction of pedestrian and bicycle conflicts on these two major roads thereby increasing overall safety between vehicles and other modes of travel.

15. Project Cost/Budget, including other funding sources, and Schedule: The Santa Cruz County Board of Supervisors has adopted the attached resolution for the TDA project funding.

**Project Start Date: April 1, 2015, Phase I, Aptos Village Plan Improvements**

	Planning	Environmental	Design/ Engineering	ROW	Construction	Other *	Contingency	Total
<b>SCHEDULE (Month/Yr) Completion Date</b>	<b>done</b>	<b>done</b>	<b>In process</b>	<b>Done</b>	<b>4/2015 Phase I 4/2016 Phase II</b>			<b>\$1,500,000 Phase I \$2,000,000 Phase II</b>
<b>Total Cost/Phase</b>					<b>\$137,926 Phase I</b>			<b>\$137,926</b>
<b>\$TDA requested</b>					<b>\$137,926</b>			<b>\$137,926</b>
<b>Source 2: Prior TDA</b>					<b>\$0</b>			<b>\$0</b>
<b>Source 3: RSTPX</b>					<b>\$290,000 Phase I</b>			<b>\$290,000</b>
<b>Source 4: TIA Fees</b>					<b>\$1,072,074</b>			<b>\$1,072,074</b>

*\*Please describe what is included in "Other":*

16. Preferred Method and Schedule for TDA fund distribution, consistent with the RTC Rules and Regulations (a. 90% prior to completion/10% upon completion; or b. 100% after completion):  
Preferred method for TDA fund distribution is: a. 90% prior to completion/10% upon completion.

17. TDA Eligibility:

	YES?/NO?
<b>A.</b> Has the project/program been approved by the claimant's governing body? Attach resolution to claim. (If "NO," provide the approximate date approval is anticipated.)	<b>Yes</b>
<b>B.</b> Has this project previously received TDA funding?	<b>No</b>
<b>C.</b> For capital projects, have provisions been made by the claimant to maintain the project or facility, or has the claimant arranged for such maintenance by another agency for the next 20 years?	<b>Yes</b>
<b>D.</b> Has the project already been reviewed by the RTC Bicycle Committee and/or Elderly/Disabled Transportation Advisory Committee? (If "NO," project will be reviewed prior to RTC approval).	<b>No</b>
<b>E.</b> For "bikeways," does the project meet Caltrans minimum safety design criteria pursuant to Chapter 1000 of the California Highway Design Manual? (Available on the internet via: <a href="http://www.dot.ca.gov">http://www.dot.ca.gov</a> ).	<b>Yes</b>

**Documentation to Include with Your Claim:**

**All Claims**

- ☐ A letter of transmittal addressed to the SCCRTC Executive Director that attests to the accuracy of the claim and all its accompanying documentation.
- ☐ Resolution from the TDA Eligible Claimant indicating its role and responsibilities.

**Article 8 Bicycle/Pedestrian Claims**

- ☐ Evidence of environmental review for capital projects
- 

***Local Agency Certification:***

This TDA Claim has been prepared in accordance with the SCCRTC's Budget, SCCRTC's Rules and Regulations, and Caltrans TDA Guidebook (<http://www.dot.ca.gov/hq/MassTrans/State-TDA.html>). I certify that the information provided in this form is accurate and correct. I understand that if the required information has not been provided this form may be returned and the funding allocation may be delayed.

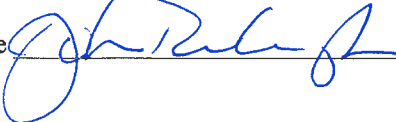
Signature  Title: Director of Public Works Date: 9/26/2014

**PROJECT NOTES (THIS SHEET)**

- 1 NEW CPUC STANDARD NO. 8 TO BE INSTALLED BY SANTA CRUZ AND MONTEREY BAY RAILWAY FORCES. CLEARANCE FROM CENTER OF WARNING DEVICE POLE TO FACE OF CURB SHALL BE A MINIMUM OF 4'5".
- 2 NEW CPUC STANDARD NO. 9-A TO BE INSTALLED BY SANTA CRUZ AND MONTEREY BAY RAILWAY FORCES. CLEARANCE FROM CENTER OF WARNING DEVICE POLE TO FACE OF CURB SHALL BE A MINIMUM OF 4'5".
- 3 EXISTING CPUC STANDARD NO. 8 TO BE REMOVED BY SANTA CRUZ AND MONTEREY BAY RAILWAY FORCES.
- 4 EXISTING RR SIGNAL HOUSE TO BE REMOVED BY SANTA CRUZ AND MONTEREY BAY RAILWAY FORCES.
- 5 EXISTING RAILROAD RUBBER PANEL TO BE REMOVED AND NEW 8'x70' RAILROAD CONCRETE PANEL TO BE INSTALLED BY SANTA CRUZ AND MONTEREY BAY RAILWAY FORCES.
- 6 NEW RAILROAD SIGNAL HOUSE TO BE INSTALLED BY SANTA CRUZ AND MONTEREY BAY RAILWAY FORCES.
- 7 NEW TYPE 1 PEDESTRIAN BARRICADE PER CALTRANS STANDARD PLAN ES-7P WITH RR-36 SIGN.
- 8 ADDITIONAL FLASHING-LIGHT SIGNALS FOR EASTBOUND AND WESTBOUND APPROACHES MOUNTED ON WARNING DEVICE POLE (IN ADDITION TO FLASHING-LIGHT SIGNALS MOUNTED ON WARNING DEVICE POLE (IN ADDITION TO FLASHING-LIGHT SIGNALS FOR SOUTHBOUND APPROACH) TO BE FURNISHED AND INSTALLED BY SANTA CRUZ AND MONTEREY BAY RAILWAY FORCES.
- 9 ADDITIONAL FLASHING-LIGHT SIGNALS FOR WESTBOUND APPROACH MOUNTED ON WARNING DEVICE POLE (IN ADDITION TO FLASHING-LIGHT SIGNALS FOR SOUTHBOUND APPROACH) TO BE FURNISHED AND INSTALLED BY SANTA CRUZ AND MONTEREY BAY RAILWAY FORCES.
- 10 NEW DETECTABLE/NOISE WARNING SURFACE.

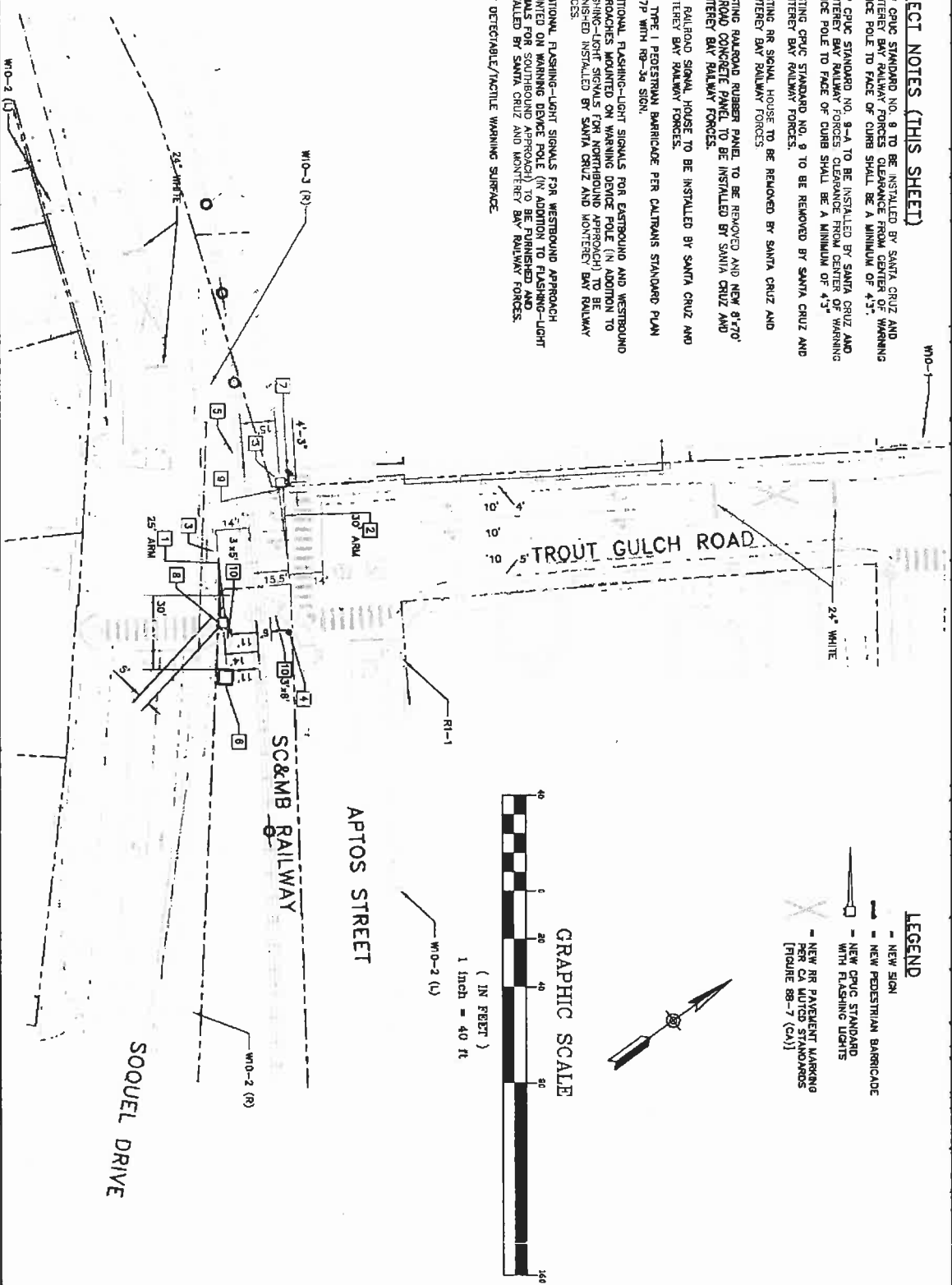

**LEGEND**

- NEW SIGN
- NEW PEDESTRIAN BARRICADE
- NEW CPUC STANDARD WITH FLASHING LIGHTS
- NEW RR PAVEMENT MARKING PER CA MUTCD STANDARDS (FIDUCIAL 88-7 (CA))



**Hatch Mott MacDonald**  
 1300-B FIRST STREET  
 Q. BOX, CA 95020  
 (916) 881-1122  
 WWW.HATCHMOTT.COM

COUNTY OF SANTA CRUZ - DEPARTMENT OF PUBLIC WORKS SOQUEL DRIVE TRAFFIC SIGNAL & RAILROAD XING IMPROVEMENT PROJECT SOQUEL DRIVE/TROUT GULCH ROAD RAILROAD XING LAYOUT	PROJECT ENGINEER LEOPOLDO TRUJILLO	EXHIBIT E2	DATE: 06.13.13 DESIGNED: LT CHECKED: LT SCALE: 1"=40'
---	---------------------------------------	---------------	--

Project: 0520-0313130000 Apes Village Project\140 Drawings\14.2 design\131004 01-RR Signal 4.dwg  
 Sep 11, 2013, 12:03

APTOS VILLAGE IMPROVEMENT PROJECT – PHASE I



SOQUEL DRIVE EAST OF TROUT GULCH – PROPOSED BUS STOP LOCATION



SOQUEL DRIVE SIDEWALK – PROPOSED ADA IMPROVEMENTS



APTOS VILLAGE IMPROVEMENT PROJECT – PHASE I



TROUT GULCH ROAD – PROPOSED ADA IMPROVEMENTS



TROUT GULCH ROAD – PROPOSED SIDEWALK IMPROVEMENTS



# COUNTY OF SANTA CRUZ

0334

BEEN POSTED AT THE CLERK  
SUPERVISORS OFFICE FOR A

## PLANNING DEPARTMENT

PERIOD COMMENCING 2/25 2010  
AND ENDING 3/27 2010  
701 OCEAN STREET, 4<sup>TH</sup> FLOOR, SANTA CRUZ, CA 95060  
(831) 454-2580 FAX: (831) 454-2131 TDD: (831) 454-2123

TOM BURNS, PLANNING DIRECTOR

## NEGATIVE DECLARATION AND NOTICE OF DETERMINATION

Application Number: N/A

APN(S): 039-241-03; 039-311-55; 040-213-03; 040-213-06, -07; 040-213-13, -14, -21; 040-221-08; 041-011-03, -09, -20, -24, -32 through -35; 041-021-04 through -08, 041-021-11 through -13, -16 through -18, -26 through -29, -38, -40; -41; 041-022-01 through -16; 041-042-02 through -04, -38, -39, -42, -46; -47; 041-561-01 through -06

The project consists of the adoption of the Aptos Village Plan, including a General Plan Amendment and Rezoning. The Aptos Village Plan establishes the guidelines and parameters for the future development of the mostly vacant area between Trout Gulch Road and Aptos Creek Road (north of Soquel Drive) and would replace the Aptos Village Community Design Framework (a Specific Plan) for all areas of Aptos Village.

APN: See Above

Todd Sexauer, Staff Planner

Zone District: R-1-6, RM-3, RM-3-L, RM-4, PA, PF, PE-L, PR, C-1, and C-1-L

OWNER/APPLICANT: Various/County of Santa Cruz

STAFF PLANNER: Todd Sexauer

ACTION: Adopt Mitigated Negative Declaration with Project Approval

REVIEW PERIOD ENDS: December 22, 2009

THIS PROJECT WILL BE: Considered at a public hearing by the Board of Supervisors on February 23, 2010 at the County Government Center located at 701 Ocean Street, 5<sup>th</sup> Floor Board Chambers, Santa Cruz, CA 95060.

### Findings:

This project, if conditioned to comply with required mitigation measures or conditions shown below, will not have significant effect on the environment. The expected environmental impacts of the project are documented in the Initial Study on this project, attached to the original of this notice on file with the Planning Department, County of Santa Cruz, 701 Ocean Street, Santa Cruz, California.

### Required Mitigation Measures or Conditions:

- ☐ None  
☒ Are Attached

Review Period Ends: December 22, 2009Date Approved By Environmental Coordinator: November 16, 2009

Claudia Slater  
CLAUDIA SLATER  
Environmental Coordinator  
(831) 454-5175



If this project is approved, complete and file this notice with the Clerk of the Board:

### NOTICE OF DETERMINATION

The Final Approval of This Project was Granted by Board of Supervisorson February 23, 2010. No EIR was prepared under CEQA.  
(Date)

THE PROJECT WAS DETERMINED TO NOT HAVE SIGNIFICANT EFFECT ON THE ENVIRONMENT.

Date completed notice filed with Clerk of the Board: February 25, 2010

30

#46  
2/23/10

**Transportation Development Act (TDA) – Local Transportation Funds  
CLAIM FORM  
for Bike/Ped Projects**

*If you have any questions about this claim form or would like an electronic copy of the form,  
please contact the Santa Cruz County Regional Transportation Commission at 460-3200.*

**Project Information**

1. Project Title: Bike Lane Maintenance
2. Implementing Agency: County of Santa Cruz
3. Sponsoring Agency (if different) – must be a TDA Eligible Claimant:
4. TDA funding requested this claim: \$150,000 + \$150,000 + \$135,000 = \$435,000
5. Fiscal Year (FY) for which funds are claimed: FY 2012/2013, FY 2013/2014 and FY 2014/2015
6. General purpose for which the claim is made, identified by the article and section of the Act which authorizes such claims: ☒ **Article 8 Bicycle and/or Pedestrian Facility**
7. Contact Person/Project Manager: Jack Sohriakoff, Senior Civil Engineer  
Telephone Number: (831) 454-2160 E-mail: Jack.Sohriakoff@santacruzcounty.us  
  
Secondary Contact (in event primary not available): Greg Martin, Civil Engineer  
Telephone Number: (831) 454-2160 E-mail: Greg.Martin@santacruzcounty.us
8. Project/Program Description/Scope (use additional pages, if needed, to provide details such as work elements/tasks): As in previous years these funds will be utilized by County maintenance crews and contractors to sign, re-stripe, repair, make minor improvements, and sweep bike lanes, bike routes, and bike paths maintained by the County of Santa Cruz Department of Public Works.
9. Number of people to be served/anticipated number of users of project/program:  
Estimated County population in 2012 = 266,776 people. Estimated bike riders: 4% of population = 10,670 bicyclists. Bike riders consist of commuters, students, and recreational users. These are considered direct users to be served. However, to a certain extent, all motorists sharing the roads with bike lane users are being served with enhanced traffic safety measures.
10. Project Location/Limits (attach a map and/or photos if available/applicable, include street names):  
See attached list of bike lane miles on County maintained roads. Bike lanes are generally located on major arterial roads throughout the County, with most bike lanes located within the urbanized areas of Aptos, Live Oak, Pajaro Valley, and Soquel.
11. Justification for the project. (Why is this project needed? Primary goal/purpose of the project; problem to be addressed; project benefits; importance to the community): Traffic safety is the main goal. It is anticipated that more people will ride bikes due to either a preferred life style and/or economic difficulties experienced in this area. The maintenance of roadways has been significantly reduced due to the recent economic difficulties, and the use of TDA funds to maintain these bike facilities is very critical to maintaining traffic safety.

12. Consistency and relationship with the Regional Transportation Plan (RTP) – please reference Project or Policy number:

Policy 1.1 - Ensure that adequate support is provided to maintain and operate the existing transportation system. Policy 2.1- Ensure that all major corridors provide a choice of transportation modes and are designed with multi-modal amenities such as bus stops, turnouts and shelters, bike lanes and sidewalks. Policy 4.1 – Emphasize sustainable transportation modes consistent with regional environmental policies. Policy 4.2 – Ensure that transportation projects contribute to improved regional air quality, reduce energy consumption or reduce vehicle miles traveled, or, at a minimum, do not worsen existing conditions. Policy 5.1 – Utilize limited capital resources to maximize the efficiency of the existing transportation system, and as an alternative to constructing new facilities.

13. Measures of performance, success or completion to be used to evaluate project/program:  
Not applicable – on going maintenance of existing facilities.

14. Impact(s) of project on other modes of travel, if any (ex. parking to be removed):  
Not applicable – on going maintenance of existing facilities.

15. Project Cost/Budget, including other funding sources, and Schedule: The Santa Cruz County Board of Supervisors adopted the attached resolution for the TDA project funding.

**Project Start Date: July 1, 2012, on-going bike lane maintenance**

	Planning	Environ- mental	Design/ Engineering	ROW	Construction	Other *	Contingency	Total
<b>SCHEDULE (Month/Yr) Completion Date 6/30/12</b>					<b>7/1/2012 thru 6/30/2015</b>			<b>\$435,000</b>
<b>Total Cost/Phase</b>					<b>\$435,000</b>			<b>\$435,000</b>
<b>STDA requested</b>					<b>\$435,000</b>			<b>\$435,000</b>
<b>Source 2: Prior TDA</b>					<b>\$179,674</b>			<b>\$179,674</b>
<b>Source 3:</b>								
<b>Source 4:</b>								

*\*Please describe what is included in "Other":*

16. Preferred Method and Schedule for TDA fund distribution, consistent with the RTC Rules and Regulations (a. 90% prior to completion/10% upon completion; or b. 100% after completion):  
Preferred method for TDA fund distribution is: a. 90% prior to completion/10% upon completion.

17. TDA Eligibility:

	YES?/NO?
A. Has the project/program been approved by the claimant's governing body? Attach resolution to claim. (If "NO," provide the approximate date approval is anticipated.)	Yes
B. Has this project previously received TDA funding?	Yes
C. For capital projects, have provisions been made by the claimant to maintain the project or facility, or has the claimant arranged for such maintenance by another agency for the next 20 years?	Yes
D. Has the project already been reviewed by the RTC Bicycle Committee and/or Elderly/Disabled Transportation Advisory Committee? (If "NO," project will be reviewed prior to RTC approval).	No
E. For "bikeways," does the project meet Caltrans minimum safety design criteria pursuant to Chapter 1000 of the California Highway Design Manual? (Available on the internet via: <a href="http://www.dot.ca.gov">http://www.dot.ca.gov</a> ).	Yes

**Documentation to Include with Your Claim:**

**All Claims**

- ☐ A letter of transmittal addressed to the SCCRTC Executive Director that attests to the accuracy of the claim and all its accompanying documentation.
- ☐ Resolution from the TDA Eligible Claimant indicating its role and responsibilities.

**Article 8 Bicycle/Pedestrian Claims**

- ☐ Evidence of environmental review for capital projects

***Local Agency Certification:***

This TDA Claim has been prepared in accordance with the SCCRTC's Budget, SCCRTC's Rules and Regulations, and Caltrans TDA Guidebook (<http://www.dot.ca.gov/hq/MassTrans/State-TDA.html>). I certify that the information provided in this form is accurate and correct. I understand that if the required information has not been provided this form may be returned and the funding allocation may be delayed.

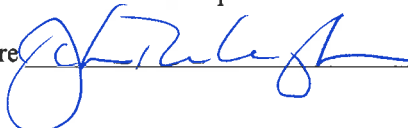
Signature:  Title: Director of Public Works Date: 9/26/2014

Jurisdiction	Bike Lane Miles thru 2014 (Bi-directional)	County of Santa Cruz Bike Lane and Path Locations
County	3.20	7th Avenue
County	3.20	17th Avenue (Soquel Avenue to Portola Drive)
County	0.90	30th Avenue ( Brommer Street to Portola Drive)
County	0.12	41st Avenue (Highway 1 to Soquel Drive)
County	0.95	41st Avenue (East Cliff Drive to City of Capitola)
County	1.10	Airport Boulevard (Pajaro Lane to Green Valley Road)
County	0.35	Amesti Road (Green Valley Road to Amesti Elementary School)
County	2.75	Brommer Street
County	0.22	Cabrillo College Drive
County	0.86	Calabasas Road (Bradford Road to Buena Vista Drive)
County	0.44	Capitola Avenue (Highway 1 to Soquel Drive)
County	2.75	Capitola Road
County	2.00	Chanticleer Avenue ( Brommer Street to Soquel Avenue)
County	0.07	Commercial Way
County	3.66	Corralitos Road
County	3.40	East Cliff Drive
County	0.32	East Walnut Street
County	1.38	Empire Grade
County	0.40	Felt Street
County	14.60	Freedom Boulevard
County	3.25	Glen Coolidge Drive
County	0.70	Green Valley Road (Holohan Road to Amesti Road)
County	0.55	Harkins Slough Road (Lee Road to Pajaro Valley High School)
County	3.04	Holohan Road
County	2.70	McGregor Drive
County	0.42	Park Avenue
County	0.35	Porter Street
County	3.52	Portola Drive
County	0.36	Robertson Street (Soquel Wharf Road to West Walnut Street)
County	1.14	Rodriguez Street
County	10.14	San Andreas Road
County	0.88	Soquel - San Jose Road (Paper Mill Road to Dawn Lane)
County	3.35	Soquel Avenue
County	15.72	Soquel Drive (Soquel Avenue to Freedom Blvd)
County	0.25	State Park Drive (Center Avenue to Highway 1)
County	0.16	State Park Drive (Highway 1 to Soquel Drive)
County	1.14	Thurber Lane
County	0.94	Trout Gulch Road
County	0.31	West Walnut Street
<b>TOTAL</b>	<b>91.59</b>	

Jurisdiction	Bike Path Miles thru 2014 (Bi-directional)	Locations
County	1.60	Freedom Boulevard near Aptos High School
County	1.00	East Cliff Drive (32nd Avenue to 41st Avenue)
County	1.40	Green Valley Road (Devon Lane to Dalton Lane)
County	0.25	Moran Way
County	2.50	Wilder Ranch (Shaffer Road)
County	0.54	Buena Vista Drive (Bradford Road to Memorial Avenue)
<b>TOTAL</b>	<b>7.29</b>	

**Transportation Development Act (TDA) – Local Transportation Funds  
CLAIM FORM  
for Bike/Ped Projects**

*If you have any questions about this claim form or would like an electronic copy of the form,  
please contact the Santa Cruz County Regional Transportation Commission at 460-3200.*

**Project Information**

1. Project Title: Sanctuary Scenic Trail – Twin Lakes State Beach
2. Implementing Agency: County of Santa Cruz
3. Sponsoring Agency (if different) – must be a TDA Eligible Claimant:
4. TDA funding requested this claim: \$5,394 + \$11,531 + \$32,996 + \$36,901 = \$86,822
5. Fiscal Year (FY) for which funds are claimed: FY 2011/2012, 2012/2013, 2013/2014 and 2014/2015
6. General purpose for which the claim is made, identified by the article and section of the Act which authorizes such claims: ☒ **Article 8 Bicycle and/or Pedestrian Facility**
7. Contact Person/Project Manager: Jack Sohriakoff, Senior Civil Engineer  
Telephone Number: (831) 454-2160 E-mail: Jack.Sohriakoff@santacruzcounty.us  
  
Secondary Contact (in event primary not available): Greg Martin, Civil Engineer  
Telephone Number: (831) 454-2160 E-mail: Greg.Martin@santacruzcounty.us
8. Project/Program Description/Scope (use additional pages, if needed, to provide details such as work elements/tasks): The County has participated in the overall planning and implementation of the Sanctuary Scenic Trail and is committed to providing funding for capital improvement projects associated with this corridor, including along the newly acquired rail line. The current programmed project is the Twin Lakes State Beach improvements which include standard pedestrian and bike facilities on East Cliff Drive fronting Twin Lakes State Beach between 5<sup>th</sup> Avenue and 7<sup>th</sup> Avenue.
9. Number of people to be served/anticipated number of users of project/program: Estimated number of visitors per year to Twin Lakes State Beach is 500,000. Estimated bike riders: 4% of visitors = 20,000 bicyclists. Estimated pedestrians: 2% of visitors = 10,000 pedestrians. Total bike and ped users = 30,000 annually.
10. Project Location/Limits (attach a map and/or photos if available/applicable, include street names):  
East Cliff Drive improvements from the harbor entrance at 5<sup>th</sup> Avenue to 7<sup>th</sup> Avenue.
11. Justification for the project. (Why is this project needed? Primary goal/purpose of the project; problem to be addressed; project benefits; importance to the community): The proposed improvements have been discussed with the community for over 15 years with its primary goal to establish an overall parking and circulation plan to accommodate the influx of peak summer seasonal traffic and parking demands, as well as year round use, and to protect the road infrastructure from wave action and erosion. The project has received all permits to proceed with construction.

12. Consistency and relationship with the Regional Transportation Plan (RTP) – please reference Project or Policy number:

Policy 2.1- Ensure that all major corridors provide a choice of transportation modes and are designed with multi-modal amenities such as bus stops, turnouts and shelters, bike lanes and sidewalks.

Policy 4.1 – Emphasize sustainable transportation modes consistent with regional environmental policies.

Policy 4.2 – Ensure that transportation projects contribute to improved regional air quality, reduce energy consumption or reduce vehicle miles traveled, or, at a minimum, do not worsen existing conditions.

13. Measures of performance, success or completion to be used to evaluate project/program:

Pedestrian and bike infrastructure improvements are to be consistent with the Sanctuary Scenic Trail master plan and the County Design Criteria. The project has been designed and constructed to meet local, state, and/or federal design standards.

14. Impact(s) of project on other modes of travel, if any (ex. parking to be removed):

The Twin Lakes State Beach project will lead to a reduction of parking in the area due to the need for formalizing on street parking in order to protect the road infrastructure. Vehicles currently park haphazardly and degrade the shoulder. A new bike lane and sidewalk will be installed on this portion of East Cliff Drive reducing the conflicts between road users.

15. Project Cost/Budget, including other funding sources, and Schedule: The Santa Cruz County Board of Supervisors adopted the attached resolution for the TDA project funding. The project has also received \$200,000 in grant funds from the SCCRTC as part of the MBSST network, and is expected to receive a \$250,000 grant from the Coastal Conservancy.

**Project Start Date: Sanctuary Scenic Trail - Twin Lakes State Beach**

	Planning	Environ- mental	Design/ Engineering	ROW	Construction	Other *	Contingency	Total
<b>SCHEDULE (Month/Yr) Completion Date</b>	<b>August 2013</b>	<b>August 2013</b>	<b>January 2015</b>	<b>Aug. 2014</b>	<b>Dec. 2015</b>			
<b>Total Cost/Phase</b>	<b>\$89,150</b>	<b>\$66,250</b>	<b>\$668,620</b>	<b>\$168, 180</b>	<b>\$4,465,100</b>			<b>\$5,457,300</b>
<b>\$TDA requested</b>					<b>\$86,822</b>			<b>\$86,822</b>
<b>Source 2: Prior TDA</b>					<b>\$0</b>			<b>\$0</b>
<b>Source 3: grants</b>					<b>\$450,000</b>			<b>\$450,000</b>
<b>Source 4: local funds</b>					<b>\$4,920,478</b>			<b>\$4,920,478</b>

*\*Please describe what is included in "Other":*

16. Preferred Method and Schedule for TDA fund distribution, consistent with the RTC Rules and Regulations (a. 90% prior to completion/10% upon completion; or b. 100% after completion):

Preferred method for TDA fund distribution is: a. 90% prior to completion/10% upon completion.



17. TDA Eligibility:

	YES?/NO?
A. Has the project/program been approved by the claimant's governing body? Attach resolution to claim. (If "NO," provide the approximate date approval is anticipated.)	Yes
B. Has this project previously received TDA funding?	No
C. For capital projects, have provisions been made by the claimant to maintain the project or facility, or has the claimant arranged for such maintenance by another agency for the next 20 years?	Yes
D. Has the project already been reviewed by the RTC Bicycle Committee and/or Elderly/Disabled Transportation Advisory Committee? (If "NO," project will be reviewed prior to RTC approval).	No
E. For "bikeways," does the project meet Caltrans minimum safety design criteria pursuant to Chapter 1000 of the California Highway Design Manual? (Available on the internet via: <a href="http://www.dot.ca.gov">http://www.dot.ca.gov</a> ).	Yes

**Documentation to Include with Your Claim:**

**All Claims**

- ☐ A letter of transmittal addressed to the SCCRTC Executive Director that attests to the accuracy of the claim and all its accompanying documentation.
- ☐ Resolution from the TDA Eligible Claimant indicating its role and responsibilities.

**Article 8 Bicycle/Pedestrian Claims**

- ☐ Evidence of environmental review for capital projects

***Local Agency Certification:***

This TDA Claim has been prepared in accordance with the SCCRTC's Budget, SCCRTC's Rules and Regulations, and Caltrans TDA Guidebook (<http://www.dot.ca.gov/hq/MassTrans/State-TDA.html>). I certify that the information provided in this form is accurate and correct. I understand that if the required information has not been provided this form may be returned and the funding allocation may be delayed.

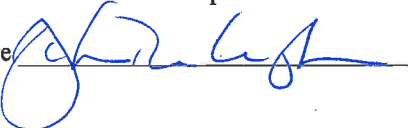
Signature:  Title: Director of Public Works Date: 9/26/2014

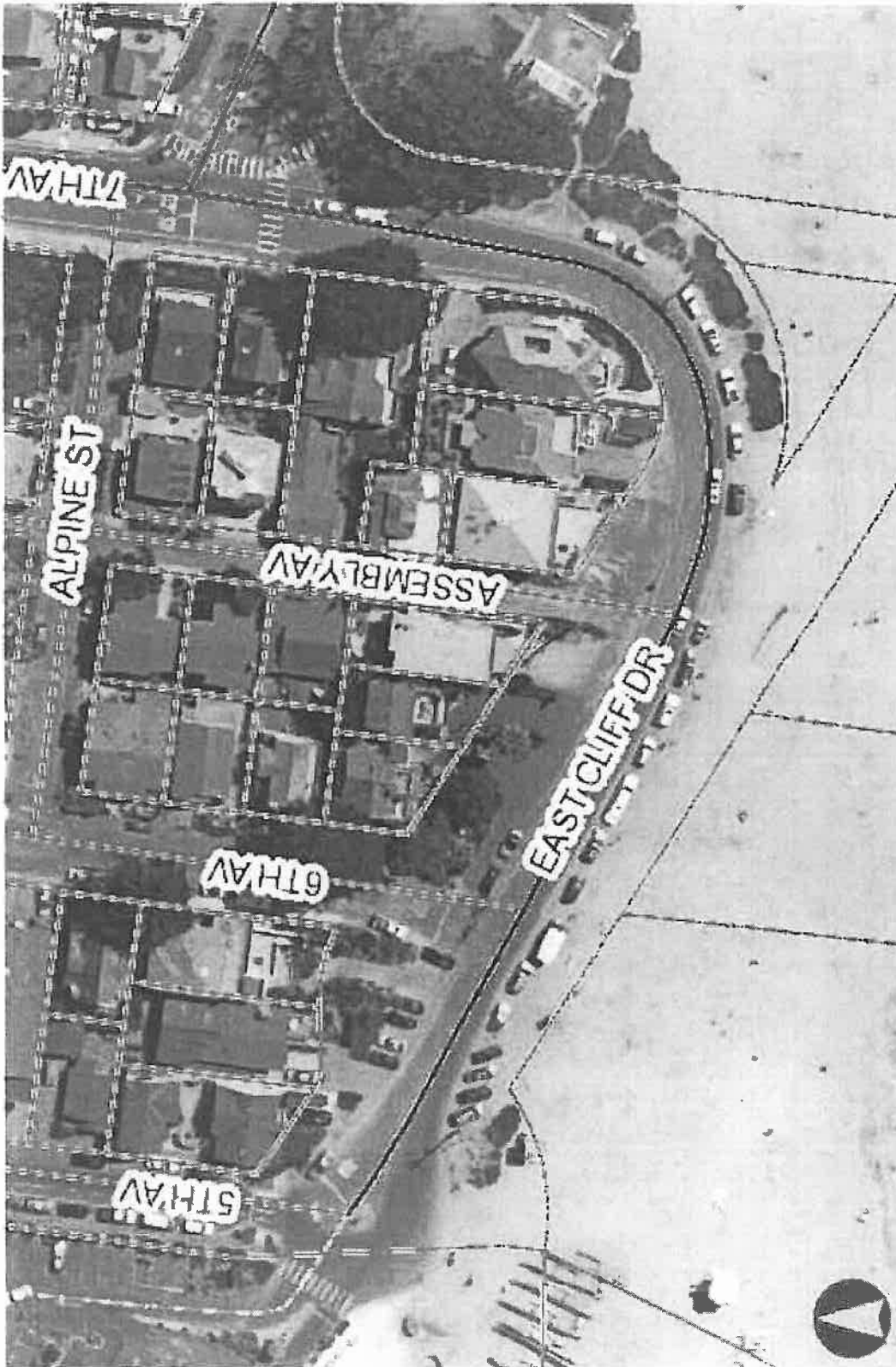

0342

Twin Lakes Beachfront – East Cliff Drive 5<sup>th</sup> to 7<sup>th</sup> Avenues  
Aerial of Existing Conditions



**Twin Lakes Beachfront Project – East Cliff Drive 5<sup>th</sup> to 7<sup>th</sup> Avenues**  
 Sketch Plan



EAST CLIFF DRIVE LOOKING TOWARD HARBOR ENTRANCE



EAST CLIFF DRIVE LOOKING TOWARD HARBOR ENTRANCE



# COUNTY OF SANTA CRUZ 0345

## PLANNING DEPARTMENT

701 OCEAN STREET, 4<sup>TH</sup> FLOOR, SANTA CRUZ, CA 95060  
 (831) 454-2580 FAX: (831) 454-2131 TDD: (831) 454-2123  
 KATHLEEN MOLLOY PREVISICH, PLANNING DIRECTOR  
<http://www.sccoplanning.com/>

### MITIGATED NEGATIVE DECLARATION

**Project:** East Cliff Drive Pedestrian Improvements Phase III APN(S): N/A, County Right-of-Way

**Project Description:** Proposal to complete roadway and roadside improvements within the East Cliff Drive public right-of-way between 5<sup>th</sup> and 7<sup>th</sup> Avenue to include parking and circulation improvements (vehicle, bicycle, and pedestrian) and a bluff protection structure on the south side of the right-of-way. The project includes the removal of a 24 inch Monterey Cypress tree, a 24 inch and 26 inch Mexican Fan Palm tree, and multiple smaller trees. The project requires a Coastal Development Permit and a Geology, Geotechnology, Seawall Design, Arborist, Preliminary Grading, Drainage, and Biotic Report Reviews.

**Project Location:** The project is located within the East Cliff Drive public right-of-way between 5<sup>th</sup> Avenue and 7<sup>th</sup> Avenue adjacent to Twin Lakes State Beach, Harbor Beach, and the Santa Cruz Yacht Harbor within the Live Oak Planning Area.

**Owner:** County of Santa Cruz

**Applicant:** Santa Cruz County Department of Public Works

**Staff Planner:** Sheila McDaniel, (831) 454-2255

**Email:** [pln056@co.santa-cruz.ca.us](mailto:pln056@co.santa-cruz.ca.us)

**This project will be considered at a public hearing by the Santa Cruz County Planning Commission on October 24, 2012 at 9:00 a.m. or thereafter in the Board of Supervisors Chambers, 701 Ocean Street, 5<sup>th</sup> Floor, Room 525, Santa Cruz, CA 95060.**

### California Environmental Quality Act Mitigated Negative Declaration Findings:

Find, that this Mitigated Negative Declaration reflects the decision-making body's independent judgment and analysis, and; that the decision-making body has reviewed and considered the information contained in this Mitigated Negative Declaration and the comments received during the public review period; and, that revisions in the project plans or proposals made by or agreed to by the project applicant would avoid the effects or mitigate the effects to a point where clearly no significant effects would occur; and, on the basis of the whole record before the decision-making body (including this Mitigated Negative Declaration) that there is no substantial evidence that the project as revised will have a significant effect on the environment. The expected environmental impacts of the project are documented in the attached Initial Study on file with the County of Santa Cruz Clerk of the Board located at 701 Ocean Street, 5<sup>th</sup> Floor, Santa Cruz, California.

Review Period Ends: October 12, 2012

Note: This Document is considered Draft until it is Adopted by the Appropriate County of Santa Cruz Decision-Making Body

Date: Oct 16, 2012

Matt Johnston  
 MATT JOHNSTON, Environmental Coordinator  
 (831) 454-3201

THIS NOTICE HAS BEEN POSTED AT THE CLERK  
 OF THE BOARD OF SUPERVISORS OFFICE FOR A

PERIOD COMMENCING 04 Aug 20 14  
 AND ENDING 03 Sept 20 14

RECEIVED  
 CLERK OF THE BOARD

AUG - 4 2014

BOARD OF SUPERVISORS  
 COUNTY OF SANTA CRUZ

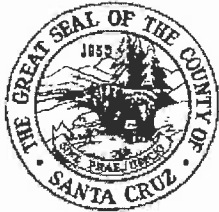

# COUNTY OF SANTA CRUZ

## PLANNING DEPARTMENT

701 OCEAN STREET, 4<sup>TH</sup> FLOOR, SANTA CRUZ, CA 95060  
(831) 454-2580 FAX: (831) 454-2131 TDD: (831) 454-2123  
KATHLEEN MOLLOY PREVISICH, PLANNING DIRECTOR  
<http://www.sccoplanning.com/>

0346

## NOTICE OF DETERMINATION

### To:

☒ County of Santa Cruz  
Clerk of the Board  
701 Ocean Street, Room 500  
Santa Cruz, CA 95060

☒ Office of Planning and Research  
State Clearinghouse  
P.O. Box 3044  
Sacramento, CA 95812-3044

### Subject: Filing of Notice of Determination in compliance with Section 21108 or 21152 of the Public Resources Code.

State Clearinghouse Number (if applicable): 2012042035

Project Title: East Cliff Drive Pedestrian Improvements Phase III

Project Applicant: County of Santa Cruz - Department of Public Works

Project Location: The project is located within the East Cliff Drive public right-of-way between 5<sup>th</sup> Avenue and 7<sup>th</sup> Avenue adjacent to Twin Lakes State Beach, Harbor Beach, and the Santa Cruz Yacht Harbor within the Live Oak Planning Area, in Santa Cruz County.

**Project Description:** Proposal to complete roadway and roadside improvements within the East Cliff Drive public right-of-way between 5<sup>th</sup> and 7<sup>th</sup> Avenue to include parking and circulation improvements (vehicle, bicycle, and pedestrian) and a bluff protection structure on the south side of the right-of-way. The project includes the removal of a 24 inch Monterey Cypress tree, a 24 inch and 26 inch Mexican Fan Palm tree, and multiple smaller trees.

This is to advise that the County of Santa Cruz has approved the above described project on 10/24/12  
and has made the following determinations regarding the above described project: (Date)

1. The project [ ☐ will ☒ will not ] have a significant effect on the environment.
2. ☐ An Environmental Impact Report was prepared for this project pursuant to the provisions of CEQA.  
☒ A Negative Declaration was prepared for this project pursuant to the provisions of CEQA.
3. Mitigation Measures [ ☒ were ☐ were not ] made a condition of the approval of the project.
4. A mitigation reporting or monitoring plan [ ☒ was ☐ was not ] adopted for this project.
5. A statement of Overriding Considerations [ ☐ was ☒ was not ] adopted for this project.
6. Findings [ ☒ were ☐ were not ] made pursuant to the provisions of CEQA.

This is to certify that the Final EIR with comments and responses and record of project approval, or the Negative Declaration, is available to the General Public at the following location:

County of Santa Cruz Planning Department  
701 Ocean Street, 4<sup>th</sup> Floor  
Santa Cruz, CA 95060

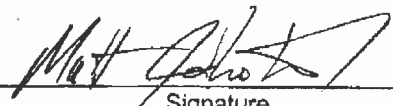
  
\_\_\_\_\_  
Signature  
8/14/14  
\_\_\_\_\_  
Date Received for Filing at Clerk of the Board

Environmental Coordinator  
\_\_\_\_\_  
Title

10/16/12  
\_\_\_\_\_  
Date

\_\_\_\_\_  
Date Received for filing at OPR

Updated 12/11

**Transportation Development Act (TDA) – Local Transportation Funds  
CLAIM FORM  
for Bike/Ped Projects**

*If you have any questions about this claim form or would like an electronic copy of the form,  
please contact the Santa Cruz County Regional Transportation Commission at 460-3200.*

**Project Information**

1. Project Title: County Government Center ADA Path
2. Implementing Agency: County of Santa Cruz
3. Sponsoring Agency (if different) – must be a TDA Eligible Claimant:
4. TDA funding requested this claim: \$15,000
5. Fiscal Year (FY) for which funds are claimed: FY 2014/2015
6. General purpose for which the claim is made, identified by the article and section of the Act which authorizes such claims: ☒ **Article 8 Bicycle and/or Pedestrian Facility**
7. Contact Person/Project Manager: Jack Sohriakoff, Senior Civil Engineer  
Telephone Number: (831) 454-2160 E-mail: Jack.Sohriakoff@santacruzcounty.us  
  
Secondary Contact (in event primary not available): Greg Martin, Civil Engineer  
Telephone Number: (831) 454-2160 E-mail: Greg.Martin@santacruzcounty.us
8. Project/Program Description/Scope (use additional pages, if needed, to provide details such as work elements/tasks): This capital improvement project will implement an ADA pedestrian path of travel from the existing bus stop on Ocean Street to the County building. The project costs are approximately \$95,000.
9. Number of people to be served/anticipated number of users of project/program: Estimated employees/visitors to County Government Center = 500,000 people annually. Estimated pedestrians to use new ADA path from Ocean Street through parking lot to County building: 25% of employees and visitors arrive by vehicle and park in parking lot or arrive by transit = 125,000 pedestrians. These are considered annual users that can be directly served by these improvements at the County facility.
10. Project Location/Limits (attach a map and/or photos if available/applicable, include street names):  
The limits of the improvements are from the sidewalk on Ocean Street to the front of the County building.
11. Justification for the project. (Why is this project needed? Primary goal/purpose of the project; problem to be addressed; project benefits; importance to the community): The goal is to provide ADA infrastructure for pedestrians around County Government Center which will increase overall safety.

12. Consistency and relationship with the Regional Transportation Plan (RTP) – please reference Project or Policy number:

Policy 2.1- Ensure that all major corridors provide a choice of transportation modes and are designed with multi-modal amenities such as bus stops, turnouts and shelters, bike lanes and sidewalks.

Policy 4.1 – Emphasize sustainable transportation modes consistent with regional environmental policies.

Policy 4.2 – Ensure that transportation projects contribute to improved regional air quality, reduce energy consumption or reduce vehicle miles traveled, or, at a minimum, do not worsen existing conditions.

13. Measures of performance, success or completion to be used to evaluate project/program:  
Infrastructure improvements are to be consistent with ADA requirements and all relative design criteria standards.

14. Impact(s) of project on other modes of travel, if any (ex. parking to be removed):  
No impacts on other modes of travel anticipated.

15. Project Cost/Budget, including other funding sources, and Schedule: The Santa Cruz County Board of Supervisors has adopted the attached resolution for the TDA project funding.

**Project Start Date: April 1, 2015, Phase I, Aptos Village Plan Improvements**

	Planning	Environmental	Design/ Engineering	ROW	Construction	Other *	Contingency	Total
<b>SCHEDULE (Month/Yr) Completion Date</b>	<b>done</b>	<b>done</b>	<b>complete</b>	<b>Done</b>	<b>11/2014</b>			<b>\$95,000</b>
					<b>3/2015</b>			
<b>Total Cost/Phase</b>								
<b>\$TDA requested</b>					<b>\$15,000</b>			<b>\$15,000</b>
<b>Source 2: Prior TDA</b>					<b>\$0</b>			<b>\$0</b>
<b>Source 3: Local</b>					<b>\$80,000</b>			<b>\$80,000</b>
<b>Source 4:</b>								

*\*Please describe what is included in "Other":*

16. Preferred Method and Schedule for TDA fund distribution, consistent with the RTC Rules and Regulations (a. 90% prior to completion/10% upon completion; or b. 100% after completion):  
Preferred method for TDA fund distribution is: a. 90% prior to completion/10% upon completion.



17. TDA Eligibility:

	YES?/NO?
A. Has the project/program been approved by the claimant's governing body? Attach resolution to claim. (If "NO," provide the approximate date approval is anticipated.)	Yes
B. Has this project previously received TDA funding?	No
C. For capital projects, have provisions been made by the claimant to maintain the project or facility, or has the claimant arranged for such maintenance by another agency for the next 20 years?	Yes
D. Has the project already been reviewed by the RTC Bicycle Committee and/or Elderly/Disabled Transportation Advisory Committee? (If "NO," project will be reviewed prior to RTC approval).	No
E. For "bikeways," does the project meet Caltrans minimum safety design criteria pursuant to Chapter 1000 of the California Highway Design Manual? (Available on the internet via: <a href="http://www.dot.ca.gov">http://www.dot.ca.gov</a> ).	NA

**Documentation to Include with Your Claim:**

**All Claims**

- ☐ A letter of transmittal addressed to the SCCRTC Executive Director that attests to the accuracy of the claim and all its accompanying documentation.
- ☐ Resolution from the TDA Eligible Claimant indicating its role and responsibilities.

**Article 8 Bicycle/Pedestrian Claims**

- ☐ Evidence of environmental review for capital projects

***Local Agency Certification:***

This TDA Claim has been prepared in accordance with the SCCRTC's Budget, SCCRTC's Rules and Regulations, and Caltrans TDA Guidebook (<http://www.dot.ca.gov/hq/MassTrans/State-TDA.html>). I certify that the information provided in this form is accurate and correct. I understand that if the required information has not been provided this form may be returned and the funding allocation may be delayed.

Signature

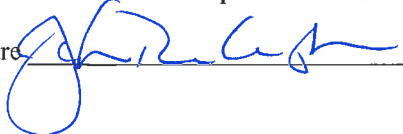

Title: Director of Public Works

Date: 9/26/2014

## COUNTY BUILDING ADA ACCESS PATH IMPROVEMENTS

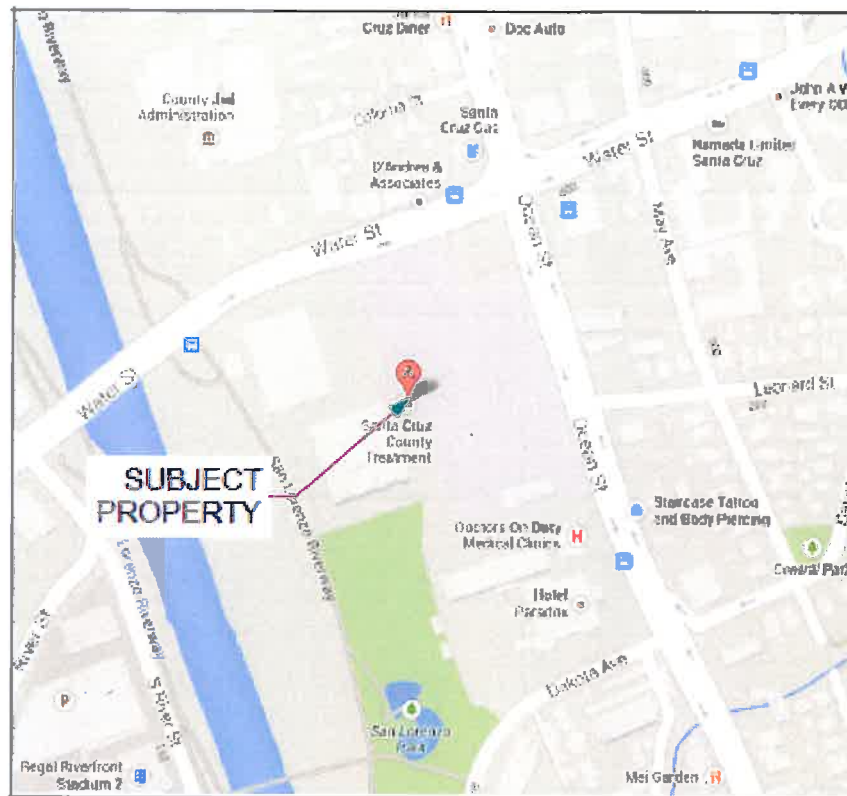

LOCATION MAPS

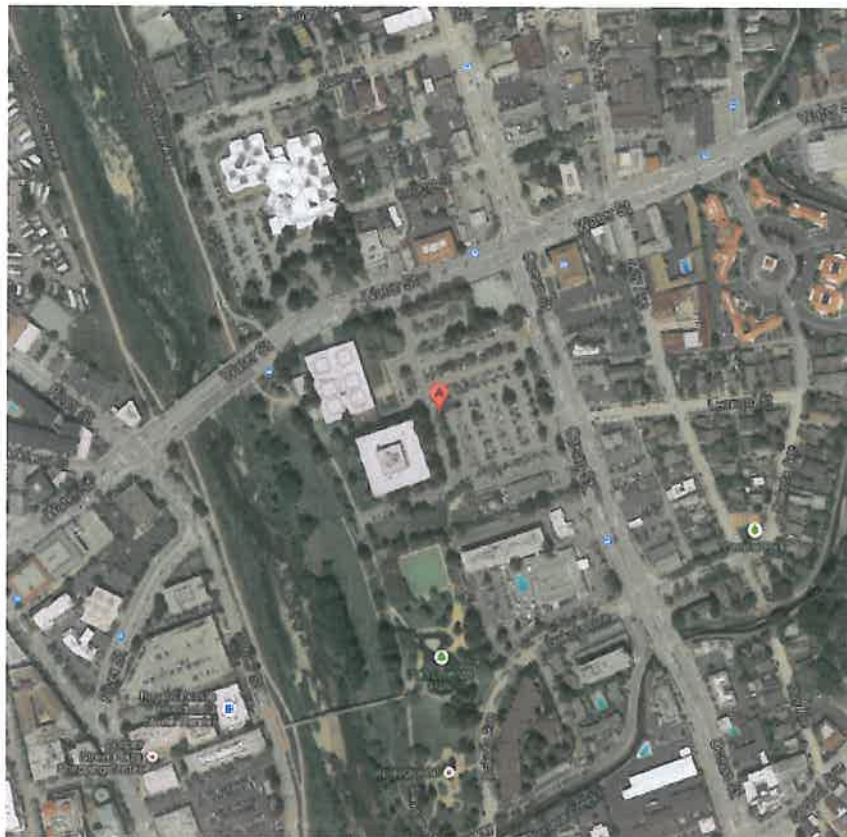

# COUNTY BUILDING ADA ACCESS PATH IMPROVEMENTS

0351

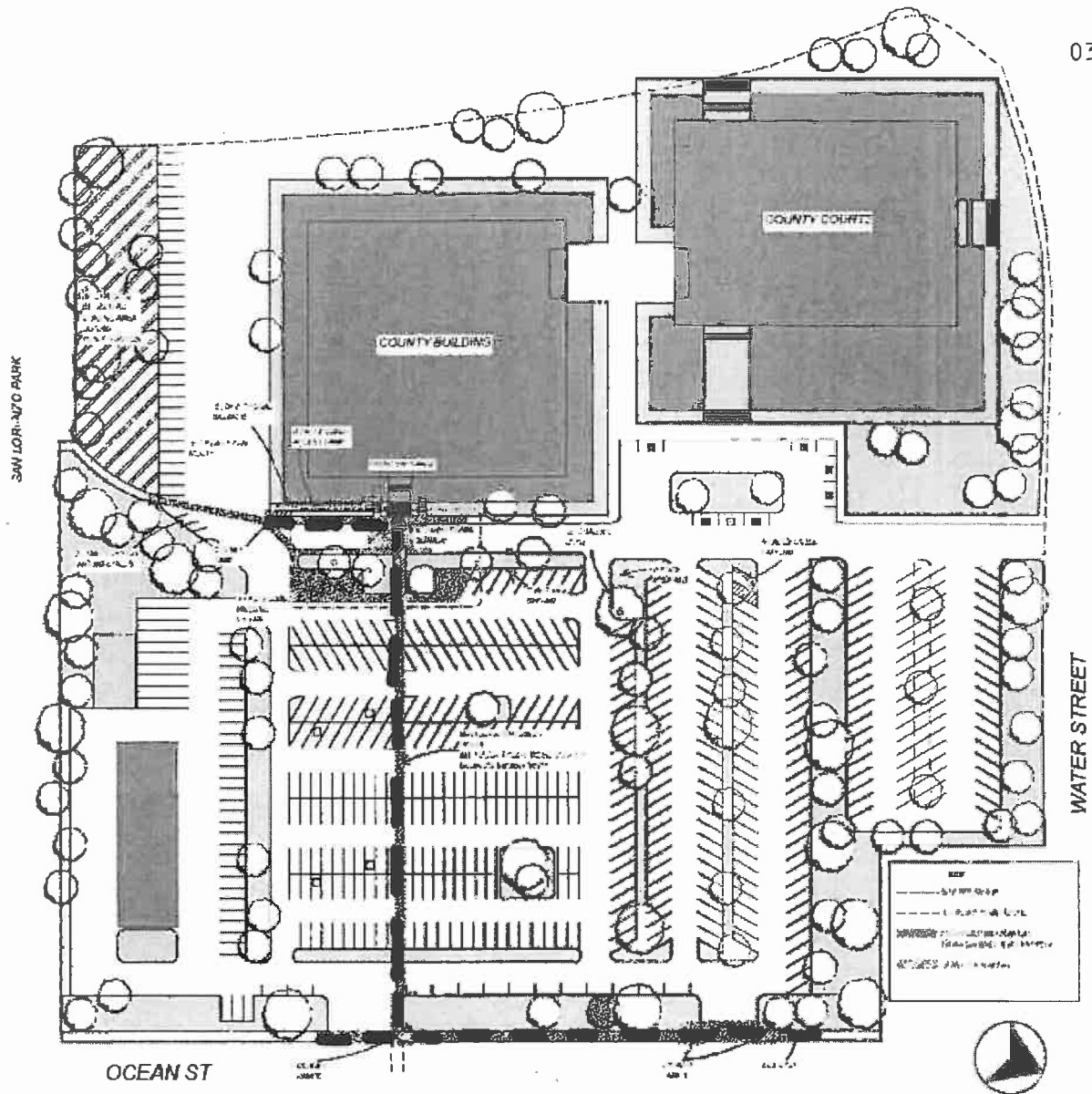

IMPROVED ADA ACCESS PATH OF TRAVEL — — —

**AGENDA:** October 14, 2014

**TO:** Elderly & Disabled Transportation Advisory Committee

**FROM:** Grace Blakeslee, Transportation Planner

**RE:** Letter of Support for 2014 Caltrans Planning Grant Applications

---

## **RECOMMENDATIONS**

Staff recommends that the Elderly and Disabled Transportation Advisory Committee (E&D TAC) provide letters of support for the 2014 Caltrans planning grant applications for City of Watsonville Complete Streets Plan, Santa Cruz County Transportation System Performance Report and Public Engagement Program to Implement the Regional Transportation Plan.

---

## **BACKGROUND**

The California Department of Transportation (Caltrans) has invited agencies to submit grant applications for planning studies to promote a balanced, comprehensive multimodal transportation system. These grants may be used for a wide range of transportation planning purposes which address local and regional transportation needs and issues.

## **DISCUSSION**

Regional Transportation Commission (RTC) staff is approved to submit Caltrans planning grant applications for the Santa Cruz County Transportation System Performance Report as the lead agency, Public Engagement Program to Implement the Regional Transportation Plan as the lead agency, and the City of Watsonville Complete Streets Plan as a sub recipient. All planning efforts have the potential to support improvements in pedestrian facilities that serve elderly and disabled individuals in Santa Cruz County.

### City of Watsonville Complete Streets Plan

If awarded, the 2014 Caltrans planning grant for the City of Watsonville Complete Streets Plan would ensure that all modes of transportation and all users of the streets are supported in an equitable fashion in the City of Watsonville. The City of Watsonville Complete Streets Plan will result in roadway designs for major arterials and collectors, priority neighborhood connections, and school zones. A list of priority complete streets transportation investments will be included in the City of Watsonville Complete Streets Plan. City of Watsonville would be the lead agency for this planning grant and RTC would serve as a sub recipient.

Santa Cruz County Transportation System Performance Report

If awarded, the 2014 Caltrans planning grant for the Santa Cruz County Transportation System Performance Report would develop a State of the Santa Cruz County Transportation System Report that would document the ongoing multimodal productivity, efficiency and quality of the transportation system based on system monitoring and performance measurement. The State of the Santa Cruz County Transportation System Report would provide system performance information to decision makers in advance of key policy and investment decisions; make critical system performance information available to the public and improve transparency of and stimulate broad community engagement in transportation planning; ensure that benefits of capital investments are realized and sustained through a coordinated approach to system management; and, evaluate progress towards community based transportation goals/targets. Pedestrian facility, usage and safety data will be recorded and evaluated as part of this planning effort.

Public Engagement Program to Implement the Regional Transportation Plan

The purpose of this application is to secure grant funding to expand Public Engagement in Santa Cruz County to raise awareness, understand priorities and build support for sustainable transportation investments. Outreach will focus on person-to-person communication at events and pop-up workshops, fruitful social media and electronic techniques, and development of easy to understand graphics with the goal of helping the diverse community members understand the importance of multimodal mobility and accessibility for all people both now and into the future.

The deadline for these Caltrans planning grant applications is October 31, 2014 for funds that would be available starting July, 2015.

**Staff recommends that the E&D TAC provide letters of support for the 2014 Caltrans planning grant applications for City of Watsonville Complete Streets Plan, the Santa Cruz County Transportation System Performance Report, and the Public Engagement Program to Implement the Regional Transportation Plan.**

**SUMMARY**

Caltrans has invited agencies to submit applications for its planning grant programs. RTC staff is approved to submit grant applications for the Santa Cruz County Transportation System Performance Report as the lead agency, Public Engagement Program to Implement the Regional Transportation Plan as the lead agency, and the City of Watsonville Complete Streets Plan as a sub recipient. Both planning efforts have the potential to support improvements in pedestrian facilities that serve elderly and disabled individuals in Santa Cruz County.



**SANTA CRUZ COUNTY REGIONAL TRANSPORTATION COMMISSION**

1523 Pacific Ave., Santa Cruz, CA 95060-3911 • (831) 460-3200 FAX (831) 460-3215 EMAIL [info@sccrtc.org](mailto:info@sccrtc.org)

September 15, 2014

Dene Bustichi, Chair  
Santa Cruz Metropolitan Transit District  
110 Vernon St.  
Santa Cruz, CA 95060

**RE: Support for purchase of new paratransit vehicles**

Dear Chair Bustichi and members of the Metro Board:

The Elderly & Disabled Transportation Advisory Committee (E&D TAC) advises the Santa Cruz County Regional Transportation Commission (RTC), the Santa Cruz Metropolitan Transit District (Metro), and other service providers on transportation needs for people with disabilities, seniors and persons with limited means.

At the August 5, 2014 meeting, the E&D TAC:

**Approved a motion to send a letter to the Santa Cruz  
Metropolitan Transit District to recommend purchase of the  
proposed new paratransit vehicles.**

Thank you for offering this opportunity to members of the E&D TAC.

Sincerely,

Michael Molesky, Chair  
Elderly and Disabled Transportation Advisory Committee

cc: Metro Board of Directors  
Alex Clifford, General Manager

*I:\E&DTAC\Letters-Outgoing\2014\Metro-NewParatransitVehiclePreview-August2014.docx*



## SANTA CRUZ COUNTY REGIONAL TRANSPORTATION COMMISSION

1523 Pacific Ave., Santa Cruz, CA 95060-3911 • (831) 460-3200 FAX (831) 460-3215 EMAIL [info@sccrtc.org](mailto:info@sccrtc.org)

September 15, 2014

Santa Cruz Metropolitan Transit District  
Board of Directors  
110 Vernon St.  
Santa Cruz, CA 95060

### **RE: Request for Input on Older Adult and Persons with Disabilities Fixed Route Discount Fare Program**

Dear Chair Bustichi and members of the Metro Board:

The Elderly & Disabled Transportation Advisory Committee (E&D TAC) advises the Santa Cruz County Regional Transportation Commission (RTC), the Santa Cruz Metropolitan Transit District, and other service providers on transportation needs for people with disabilities, seniors and persons with limited means.

At the August 5, 2014 meeting, the E&D TAC:

**Approved a motion to send a letter to the Santa Cruz Metropolitan Transit District stating that the E&D TAC supports the revisions to the Older Adult and Persons with Disabilities Fixed Route Discount Fare Program as proposed by Santa Cruz Metro staff and removal of the question related to use of service animal on the revised application.**

Thank you for requesting input from the E&D TAC on this important issue.

Sincerely,

Mike Molesky, Chair  
Elderly and Disabled Transportation Advisory Committee

cc: Leslyn Syren, METRO  
Veronica Elsea, Chair, MAC

I:\E&DTAC\Letters-Outgoing\2014\DiscountBusPassPolicy-August2014.docx

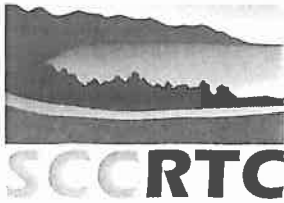

## SANTA CRUZ COUNTY REGIONAL TRANSPORTATION COMMISSION

1523 Pacific Ave., Santa Cruz, CA 95060-3911 • (831) 460-3200 FAX (831) 460-3215 EMAIL [info@sccrtc.org](mailto:info@sccrtc.org)

August 14, 2014

Keith Boyle  
Community Development Department  
City of Watsonville  
PO Box 50,000  
Watsonville, CA 95077

RE: Notice of Intent to Adopt a Negative Declaration for  
**Downtown Main Street Lane Reconfiguration**

Dear Mr. Boyle:

Thank you for the opportunity to comment on the Notice of Intent to Adopt a Negative Declaration (Neg. Dec.) for the proposed Downtown Main Street Lane reconfiguration. Santa Cruz County Regional Transportation Commission (RTC) staff would like to express its strong support for this proposed "road diet" which is consistent with the *Monterey Bay Area Complete Street Guidebook*. This project also advances the *Santa Cruz County Regional Transportation Plan* target to improve multimodal network quality (MMNQ) for walk and bicycle trips to and within key destinations. This project will add bicycle lanes, filling a critical gap in the bicycle network, and improve the quality of pedestrian facilities.

The level of use of bicycle and pedestrian facilities is highly dependent on the quality of the facility. Greater use of active transportation also helps reduce greenhouse gas emissions, reduce congestion, and improve health. These types of projects benefit all users of the roadway by providing a smoother road for drivers, decreasing conflicts between bicyclists and motorists, and creating greater separation between automobile traffic and pedestrians on sidewalks.

Studies have shown this type of treatment will also not have a significant impact on traffic. The project includes appropriate transitions at intersections, the addition of turn lanes, and removal of split phase traffic signals to ensure no notable change to the Level of Service at intersections as a result of the project.

Thank you for the opportunity to comment. If you have any questions about these comments, please contact Rachel Moriconi of my staff at (831) 460-3203.

Sincerely,

George Dondero  
Executive Director

CC: SCCRTC

I:\ENVIREVU\LETTERS\2014\MainStreetRoadDietWat.docx





## SANTA CRUZ COUNTY REGIONAL TRANSPORTATION COMMISSION

1523 Pacific Ave., Santa Cruz, CA 95060-3911 • (831) 460-3200 FAX (831) 460-3215 EMAIL [info@sccrtc.org](mailto:info@sccrtc.org)

August 14, 2014

California State Coastal Conservancy  
Chair Douglas Bosco  
1330 Broadway, 13th Floor  
Oakland, CA 94612

RE: Twin Lakes Beachfront Improvement Project

Dear Chair Bosco and Conservancy Members:

The Santa Cruz County Regional Transportation Commission (RTC) and its Bicycle Advisory Committee strongly supports the Twin Lakes Beachfront Improvement Project and I urge you to approve a \$250,000 grant to this important coastal access project. In December of last year, the RTC allocated funding towards the multi-million dollar project as part of the Monterey Bay Sanctuary Scenic Trail Network funding distribution. The Twin Lakes Beachfront project will serve bicyclists and pedestrians and is part of the Trail Network Master Plan. The project will also serve as the California Coastal Trail and will provide essential safety improvements, accessibility and coastal enhancements.

Twin Lakes State Beach currently serves more than 500,000 visitors per year, has deficient parking and has no bicycle and pedestrian facilities. Public access to Twin Lakes State Beach in Santa Cruz County will be greatly improved through this project. Additionally, bike lanes, a pedestrian path, formalized parking off the sand, and ADA access to the beach will preserve and enhance the natural character of this popular beach. The improvements will provide numerous benefits for hundreds of thousands of people who enjoy Twin Lakes State Beach each year--residents and visitors alike.

I thank you for your consideration.

Sincerely,

George Dondero  
Executive Director

cc: Trish Chapman, Project Manager, California Coastal Conservancy  
Neal Coonerty, Santa Cruz County Supervisor, 3rd District  
Santa Cruz County Regional Transportation Commission's Bicycle Advisory Committee

\\\\RTCSERV2\\Shared\\Bike\\Committee\\CORR\\BC2014\\TwinLakes\_CaCostalCons\_support\_ltr.docx

# **SANTA CRUZ METROPOLITAN TRANSIT DISTRICT**

**DATE:** September 26, 2014

**TO:** Board of Directors

**FROM:** Erron Alvey, Purchasing Manager

**SUBJECT: CONSIDERATION OF ISSUING A FORMAL REQUEST FOR PROPOSALS FOR FACILITIES EVALUATION FOR ADA COMPLIANCE**

## **I. RECOMMENDED ACTION**

**Authorize the Purchasing Manager to issue a formal Request for Proposals to obtain the services of a consultant to perform an evaluation of Santa Cruz METRO facilities for ADA compliance.**

## **II. SUMMARY**

- Santa Cruz METRO requires the professional services of a consultant to perform an evaluation of all of Santa Cruz METRO's publicly accessible facilities for compliance with the Americans with Disabilities Act (ADA).
- As part of this analysis, Santa Cruz METRO will include accessibility of equipment providing automated services to ensure ADA compliance.
- Santa Cruz METRO last performed a Facilities Analysis for ADA compliance in 2008.

## **III. DISCUSSION**

The Americans with Disabilities Act of 1990 was revised in 2010 (taking affect March 15, 2011), amending regulations for state and local governments. As a local government agency, Santa Cruz METRO is required to comply with all requirements of the ADA which includes periodic review of its facilities. The services of a professional consultant are required to review all Santa Cruz METRO's publicly assessable buildings and equipment, to report on the findings, and recommend any corrective actions should there be any areas of concern.

Such a review was last performed in 2008. As such, Santa Cruz METRO must periodically review its facilities and equipment to determine compliance with ADA standards, including, changes to both the structures and ADA requirements. These reviews assure both the agency and the public that it has evaluated and assessed the state of its facilities for accessibility by all members of the community.

#### **IV. FINANCIAL CONSIDERATIONS**

This action will authorize the initiation of a procurement estimated to have a resulting contract with a value of \$75,000.

#### **V. ALTERNATIVES**

- Do not obtain these consultant services and rely on in-house analysis on a case-by-case basis. This is not recommended as these types of consultants are typically certified and experts in accessibility laws. Santa Cruz METRO will benefit from being proactive and ensuring compliance before the possibility of a formal complaint.

#### **VI. ATTACHMENTS**

**Attachment A:** Authorizing Resolution

Prepared By: Erron Alvey, Purchasing Manager  
Date Prepared: August 19, 2014

**APPROVED:**

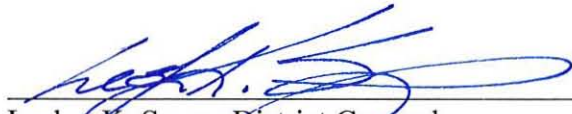
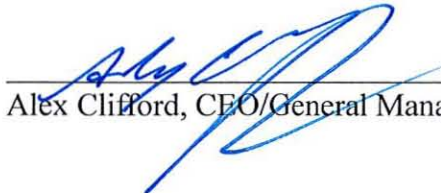
  
\_\_\_\_\_  
Leslyn K. Syren, District Counsel  
\_\_\_\_\_  
Alex Clifford, CEO/General Manager

# SANTA CRUZ METROPOLITAN TRANSIT DISTRICT

**DATE:** September 12, 2014

**TO:** Board of Directors

**FROM:** Carolyn Derwing, Schedule Analyst/Acting Planner

**SUBJECT: CONSIDERATION OF A RESOLUTION TO SET A PUBLIC HEARING TO DISCUSS POSSIBLE OPTIONS FOR THE ROUTE 6**

## I. RECOMMENDED ACTION

**That the Board of Directors adopt a Resolution to set a public hearing on October 24, 2014, to discuss possible options for the Route 6.**

## II. SUMMARY OF ISSUES

- Service to the area of Frederick Street and Gault Street by the Route 6 was discontinued in 2002. Service to the same area by the Route 65 was discontinued in 2004.
- In 2013, residents of the La Posada Retirement Community petitioned Santa Cruz Metro to reinstate bus service to the Frederick and Gault area.
- On June 28, 2013, the Board approved the reinstatement of the Route 6 on a one year trial basis.
- METRO was able to acquire funding for this one year trial from the Santa Cruz County Regional Transportation Commission (SCCRTC).
- The new Route 6 began operating on September 12, 2013 with the start of the Fall Bid.
- As of September 2014, the Route 6 will have been in operation for one year.
- Staff recommends that the Board hold a public hearing to discuss possible options for the Route 6 moving forward.

## III. DISCUSSION/BACKGROUND

Prior to 2002, the Route 6 provided hourly service between the hours of 6:50am and 6:50pm. At that time, the Route 6 departed the Santa Cruz Metro Center and served Broadway, Seabright, the Twin Lakes area and then Frederick and Gault before returning to the Santa Cruz Metro Center. This rendition of the Route 6 averaged 8.3 passengers per trip and the service was discontinued in 2002 due to low ridership and because most of the area along the Route 6 was covered by other service such as the Routes 12, 65 and 68.

In 2004 the Route 65, which had been providing service to the La Posada area, was also cut. The Route 65 operated from approximately 6:40am to 6:40pm and provided hourly service in both the inbound and outbound direction between the Santa Cruz Metro Center

and the Capitola Mall. At the time the Route 65 was cut, it was averaging 10.9 passengers per trip. The Route 65 was cut due to lower ridership and the availability of other routes that serviced similar areas such as the Routes 66, 68 and 69 at a time when funding was an issue.

In 2013, Santa Cruz METRO received a petition from the residents of the La Posada Retirement Community requesting the reinstatement of transit service in the Frederick and Gault area of Santa Cruz. La Posada is located at 609 Frederick Street, approximately one block from Soquel Avenue. In April of 2013, Santa Cruz METRO staff met with over 20 residents of La Posada to discuss the challenges that they experienced accessing the bus stops along Soquel. The residents expressed many concerns including poor sidewalk conditions and the short length of time given by the traffic light at Soquel and Frederick to allow pedestrians to cross Soquel Avenue. A lack of a safe path of travel was the primary reason why La Posada residents were requesting the return of METRO bus service directly to the Frederick and Gault area.

On June 28, 2013, the METRO Board voted to reinstate the Route 6 on a one year trial basis. At that time, a minimum threshold of eight riders per trip was set. The Board also directed staff to continue to pursue other options including capital improvements along the Frederick Street corridor. This one year trial was later funded by the Santa Cruz County Regional Transportation Commission.

On July 23, 2014, a group composed of METRO employees, City of Santa Cruz employees, the Mayor of Santa Cruz and residents of La Posada met to conduct an on-site examination of the physical obstacles that exist between La Posada and the bus stops along Soquel Avenue. As of this date, several of the issues have been mitigated by the City. The City is still following up on the timing of the pedestrian crossing at Soquel and Frederick.

It is now one year since the METRO began the “one-year trial” with the Route 6. Over the past twelve months the Route 6 has been averaging 1.9 – 3.1 passengers per trip. METRO staff is recommending that the Board hold a public hearing on October 24, 2014, to discuss possible options for the Route 6, and service to the Frederick and Gault area, going forward.

#### **IV. FINANCIAL CONSIDERATIONS/IMPACT**

Costs of advertising a Public Hearing – approximately \$900.

#### **V. ALTERNATIVES CONSIDERED**

- Take no action.

**VI. ATTACHMENTS**

- Resolution to set a public hearing on October 24, 2014 to discuss possible options for the Route 6.

Prepared By: Carolyn Derwing, Schedule Analyst/Acting Planner  
Date Prepared: September 3, 2014

APPROVED:



Leslyn Syren, District Counsel



Alex Clifford, CEO



# **SANTA CRUZ METROPOLITAN TRANSIT DISTRICT**

**DATE:** October 14, 2014

**TO:** Elderly and Disabled Transportation Advisory Committee (E&DTAC)

**FROM:** Thomas Hiltner, Grants/Legislative Analyst  
Claire Fliesler, Transit Planner

**SUBJECT: RECEIVE AN UPDATE PRESENTATION ON THE REDESIGN OF PACIFIC STATION.**

## **I. BACKGROUND**

- Pacific Station, Santa Cruz METRO's primary transit center in downtown Santa Cruz, is in poor condition and no longer meets the needs of Santa Cruz METRO.
- Santa Cruz METRO and the City of Santa Cruz are partnering to redesign Pacific Station.
- In addition to the multi-modal transit center, the project will explore what other mix of uses may be appropriate at this site.
- An extensive public outreach campaign to solicit participation is a key feature of the project contracted to Group 4 Architecture, Research + Planning (Group 4+). The third round of outreach is currently underway
- Today's oral introduction gives a project overview and status.

## **III. DISCUSSION**

Pacific Station was built in 1984 and has outlived its serviceable use. The City of Santa Cruz and Santa Cruz METRO have partnered to redesign Pacific Station with mixed-use concepts which will integrate well with the southern end of Pacific Avenue. Group 4+ will lead the design process through selection of a preferred alternative.

Santa Cruz METRO and the City of Santa Cruz kicked-off the project on July 16, 2013. Group 4+, Santa Cruz METRO, and the City of Santa Cruz have completed two rounds of stakeholder input and public participation, and the third round is currently underway. Stakeholder input and public participation events include a web and social media presence, focus groups, technical meetings, and community meetings. This iterative strategy, which responds to public input and returns modified designs to the stakeholders for additional review, will culminate with the Santa Cruz METRO Board of Directors and Santa Cruz City Council selecting a preferred alternative in December 2014.

Today's presentation is to inform the E&DTAC and invite participation in this important project.

**AGENDA: October 14, 2014**

**TO: Elderly & Disabled Transportation Advisory Committee**  
**FROM: Grace Blakeslee, RTC Staff**  
**RE: Fy13/14 Section 5310 Grant Applications**

---

**RECOMMENDATION**

Staff recommends that the Elderly & Disabled Transportation Advisory Committee:

1. Receive information about the Federal Fiscal Year 2013/14 Section 5310 grant program;
  2. Designate a local review committee to preliminarily score Section 5310 grant applications and make recommendations to the RTC; and,
  3. Consider postponement of December 9, 2014 E&D TAC meeting to January 8, 2015 to allow for review of locally determined application scores.
- 

**BACKGROUND**

Funding is available from Section 5310: Elderly & Disabled Specialized Transit Program. This grant program provides capital grants for the purchase of specialized transportation vehicles and related equipment that meets the transportation needs of elderly person and person with disabilities. Previously, eligible projects were limited to include purchase of accessible vans and buses, communication equipment, computer hardware and software. The FY 13/14 Section 5310 funding also allows for mobility management and one year of operating costs as eligible expenses. These funding sources are administered by Caltrans under the direction of the California Transportation Commission. Santa Cruz County is considered under the small and rural community's portion of this program. Approximately \$13 million is available for small and rural communities this grant cycle. Funding for small and rural communities is awarded on a competitive basis, rather than by formula allocation.

**DISCUSSION**

The Section 5310 grant applications are due December 1, 2014 to the Santa Cruz County Regional Transportation Commission (RTC), which serves as the regional transportation planning agency. The locally prepared application scores must be approved by the RTC at the January 15<sup>th</sup>, 2015 meeting and forwarded to Caltrans by February 2, 2015. A fact sheet for the program is attached (Attachment 1). The Section 5310 grant application will be available beginning October 1, <http://www.dot.ca.gov/hq/MassTrans/5310.html>.

The Moving Ahead for Progress in the 21<sup>st</sup> Century Act (MAP-21) created a new provision for the Section 5310 grant program, referred to as the Section 5310 "Expanded Projects". The "Expanded Projects" program is intended to replace the previous New Freedom grant program. Projects eligible under the Section 5310 Expanded Projects category include vehicles, operating assistance, mobility management, and other equipment. Projects eligible under the "Traditional Program" include vehicle and other equipment.

The maximum project cost for Section 5310 projects, including both “traditional” and “expanded projects”, is \$300,000. Equipment, not including vehicles, is limited to the \$40,000 for the entire request, with a minimum of \$1,000. All projects must be derived from a Coordinated Public Transit-Human Services Transportation Plan

[http://www.dot.ca.gov/hq/MassTrans/Docs-](http://www.dot.ca.gov/hq/MassTrans/Docs-Pdfs/CoordinatedPlng/2007Plans/Monterey.pdf)

[Pdfs/CoordinatedPlng/2007Plans/Monterey.pdf](http://www.dot.ca.gov/hq/MassTrans/Docs-Pdfs/CoordinatedPlng/2007Plans/Monterey.pdf), adopted in 2008.

Several Section 5310 Application Workshops will be held in October (Attachment 2).

In years past, a local review committee was formed to review the applications and score projects consistent with Caltrans scoring criteria. RTC staff requests the E&D TAC assist with identifying agencies to participate in the Section 5310 application scoring. Entities that have assisted in the past include: Santa Cruz Metropolitan Transit District, Seniors Council, and Commission on Disabilities. Project scores will be forwarded to Caltrans staff for consideration for funding amongst all projects submitted by small and rural communities throughout California.

Participants in the FTA Section 5310 local review committee should be aware of the following dates:

- December 1 - RTPA (RTC) Application deadline
- December 2 - Applications distributed to local review committee
- December 4 -16- Local review committee independently scores applications
- December 16, 18 or 19- Local review committee meets to review scoring. Applicants are encouraged to attend the scoring review meeting to obtain feedback on grant application. Final scores may be contingent upon applicant submitting revised application.
- December 31 – Revised applications due to RTPA (RTC)
- January 6- E&D TAC meeting to review application scores- *pending E&D TAC approval to change meeting date*
- January 15- RTC approves scores
- February 2- Locally determined scores submitted to Caltrans

**Staff recommends that a local review committees be established to score the Section 5310 grant applications and the E&D TAC consider postponement of December 9, 2014 E&D TAC meeting to January 8, 2015 to allow for review of locally determined application scores.**

Attachment 1: Section 5310 Fact Sheet

Attachment 2: FTS 5310 Workshop

*I:\E&DTAC\SECT5310\2014\EVALUATIONCOMMITTEE\5310REVIEWCOMSELECT-E&D.DOCX*

## PROGRAM FACT SHEET AND TIMELINE

**Program Purpose:** Provide capital grants for projects that meet the transportation needs of elderly persons and persons with disabilities where public mass transportation services are otherwise unavailable, insufficient or inappropriate.

**Program History:** Since the program's inception in 1975, approximately 500 agencies have received over 4000 vehicles statewide, serving a variety of

### Funds Available

- \* Approximately \$13 million in Federal funds are available for this two year cycle (small-urban and rural);
- \* 100 % in federal funds upon FTA approval of Transportation Development Credits.

client groups and programs ranging from small agencies with specific clientele (e.g. dialysis and AIDS patients) to large providers serving an entire community. The average cost for yearly maintenance for a vehicle is estimated at \$8,500.

### Eligible Applicants:

- \* Private non-profit corporations;
- \* Public agencies where no private non-profits are readily available to provide the proposed service;
- \* Public agencies that have been approved by the State to coordinate services.

### Eligible Equipment:

- \* Accessible vans and buses;
- \* Mobile radios and communication equipment;
- \* Computer hardware and software

### New Eligible Projects:

- \* Mobility Management
- \* Operating

**Service Eligibility:** Services to be provided must serve the transportation needs of elderly persons and/or persons with disabilities. Public service must be "incidental" per FTA C 9070.1F.

**Project Eligibility:** Applicants must have management oversight and control over the operations and service of the equipment. Applicants are required to provide sufficient justification and provide documentation that

alternative transportation services are unavailable, insufficient or inappropriate to meet the agency's transportation needs.

**Selected project vehicle(s) must provide a minimum of 20 hours of service per week per vehicle or in coordination with other agencies.**

All projects selected for funding must be derived from a Coordinated Public Transit-Human Services Transportation Plan (Coordinated Plan) as required by FTA C 9070.1F.

**Vehicle Replacement Eligibility:** Vehicle(s) must be in active service. Active service is defined as a vehicle providing service throughout the agency's normal days and hours of operation. A van(s) proposed for replacement must have been in service for four years or have at least 100,000 miles at the time of application. A replacement bus(s) must meet or exceed useful life at the time of application.

**Service Expansion Eligibility:** Applicants must be able to document that the proposed transportation service will provide:

- \* Services to additional persons; or
- \* Expand the service area or hours; or
- \* Increase the number and/or frequency of trips.

### Funding Selection Process:

1. The Regional Transportation Planning Agency (RTPA) scores the applications using established evaluation criteria and completes a prioritized list for their region.
2. The State Review Committee reviews the RTPA scores, and scores a statewide-prioritized list of projects based on available funding.
3. The California Transportation Commission (CTC) holds a public hearing to review and adopt the final list of projects.
4. Caltrans submits approved projects to the FTA.

**Program Requirements:** Once approved by FTA, successful applicants enter into a Standard Agreement with Caltrans. The agreement remains in effect until the project's useful life. Grantees are responsible for the proper use, operating costs, and maintenance of all project equipment. Grantees must be prepared to comply with the requirements of Caltrans, the Department of Motor Vehicle and the regulations of the California Highway Patrol.

**PROGRAM NOTE:**

*FTA Section 5310 vehicles are purchased by Caltrans using a State procurement process. Upon Caltrans approval, public agencies can follow their own local procurement process. However, the grantee must comply with state and federal procurement procedures when purchasing with local funds. Upon project completion, the grantee requests reimbursement from Caltrans for the Federal Share.*

**The New 5310 PROGRAM  
Enhanced Mobility of Seniors and Individuals with Disabilities  
TIMELINE**

July 1, 2014	- MAP 21 Memorandums of Understanding mailed to Option 3 Large UZAs
August 1, 2014	-MOUs signed and returned to Caltrans
Sept. 9--17, 2014	-RTPA Scoring Workshops
October 1, 2014	-Call for Projects (Caltrans and Option 3 Large UZAs)
Oct. 28 – Nov. 5, 2014	-Application Workshops for Caltrans Applicants
December 1, 2014	- Small UZAs and Rural Applications due to RTPAs
February 1, 2015	- Option 3 UZAs' Project Selection due to Caltrans by 5pm
February 1, 2015	- Small UZAs and Rural Applications due to Caltrans by 5pm
June, 2015	- CTC Adopts Prioritized List of Projects
September 30, 2015	-Grant Approved by FTA
Fall, 2015	-Successful Applicant Workshops

*For additional information call our toll free number (1.888.472.6816) or visit our website at:  
<http://www.dot.ca.gov/hq/MassTrans/5310.html>*

**FEDERAL FISCAL YEAR 2013 and 2014  
(MAP-21 FUNDING)**

**APPLICATION WORKSHOPS**

**FOR THE FEDERAL TRANSIT ADMINISTRATION PROGRAM  
SECTION 5310 "ENHANCED MOBILITY OF SENIORS AND INDIVIDUALS  
WITH DISABILITIES PROGRAM"**

**Register Now!!!**

The workshops provide a comprehensive overview of the implementation of the new MAP-21. This funding cycle is a combination of the 2013 and 2014 apportionments. Through the use of Toll Credits the projects this cycle are 100% federally funded. The purpose of the workshops is to assist agencies in understanding the grant cycle process by reviewing the general requirements and the entire application step by step.

To register for a workshop or obtain additional information please contact your 5310 liaison or the 5310 toll-free number (888) 472-6816. You may also email your RSVP in to [lan.Knutila@dot.ca.gov](mailto:lan.Knutila@dot.ca.gov)

<b>LOCATION</b>	<b>DATE</b>	<b>TIME</b>	<b>ADDRESS</b>
<b>Oakland*</b>	Tuesday October 14	1:00pm to 3:00pm	Metropolitan Transportation Commission 101 8th St Oakland, CA 94612
<b>Redding</b>	Tuesday October 28	1:00pm to 5:00pm	Caltrans District 2 Executive Conference Room 1657 Riverside Dr. Redding, CA 96001
<b>Woodland</b>	Wednesday October 29	9:00am to 1:00pm	Woodland Training Center 624 N. East Street, Woodland, CA 95776
<b>Modesto</b>	Thursday October 30	9:00am to 1:00pm	Stanislaus Council of Governments 1111 "T" Street, Suite 308 Modesto, CA 95354
<b>Orange</b>	Monday November 3	1:00pm to 5:00pm	Orange County Transportation Authority 550 S. Main Street Orange, CA 92863
<b>San Bernardino</b>	Wednesday November 5	9:00am to 1:00pm	Omnitrans 1700 W. 5 <sup>th</sup> Street San Bernardino, CA 92411

5310 Website: <http://www.dot.ca.gov/hq/MassTrans/5310.html>